



North Central Sociological
Association Annual Meeting

Marriott City Center
Pittsburgh, PA

April 12 — 15, 2012

Graduate Studies in Sociology at the University of Cincinnati

THE PROGRAM

The PhD program, which is designed to prepare students for professional careers in research and college teaching, is the center of the graduate program. We offer lots of research and teaching opportunities, and we have a good track record of placing our students in academic jobs.

AREAS OF SPECIALIZATION

Inequality, Medical sociology, Race, Gender, Urban sociology, Family, Qualitative and Quantitative methodology

THE CAMPUS

UC is a public research university with an enrollment of more than 41,000 students. It is one of the nation's top 'green universities' and, according to Forbes, one of the world's most beautiful campuses.

It is an urban campus, located two miles from down town, surrounded by historical neighborhoods.

www.artsci.uc.edu/sociology



North Central Sociological Association

Publishers of Sociological Focus

87 Years of Sociology

www.ncsanet.org



Annual Meeting
April 12—15, 2012

Marriott City Center
Pittsburgh, Pennsylvania

Renewing Sociology: Living Traditions & Creative Beginnings

2012 Program Committee Members

Program Chair: Carrie Erlin

Conference Planner: Joyce Lucke

Research Sessions: Carrie Erlin

Teaching Section: Melinda Messineo

Workshops/Panels: Lynne Richey & Melinda Messineo

High School Workshop: Debra Swanson, Katherine Rowell, and

Lynne Richey

NCSSC: Gail McGuire

Local Arrangements: Barbara Denison

2011-2012 NCSA Officers

President:	Lawrence Nichols, West Virginia University
President-Elect:	Steve Carlton-Ford, University of Cincinnati
Past President:	J.I. (Hans) Bakker, University of Guelph
Vice President:	Carrie Erlin, Saint Mary's College
Vice President-Elect:	Todd Callais, Independent Scholar
Treasurer:	Annulla Linders, University of Cincinnati
Secretary:	Barbara Denison, Shippensburg University
Member-at-Large:	Elizabeth Ross, Cleveland State University
Member-at-Large:	Mary Senter, Central Michigan University
Membership:	Mellisa Holtzman, Ball State University
Student Section:	Jennifer Carter, University of Cincinnati

2011-2012 Committee Chairs

Editor, Sociological Focus:	Gustavo Mesch, University of Haifa
NCSSC:	Gail McGuire, Indiana University South Bend
Community Colleges:	Leslie Elrod, University of Cincinnati
Nominations:	J.I. (Hans) Bakker, University of Guelph
Scholarly Achievement Award:	Steve Scanlan, The Ohio State University
A. Tomah Distinguished Service:	Jay Howard, Butler University
Finance:	Kevin Christiano, University of Notre Dame
Profession, Freedom & Responsibility:	Fayyaz Hussain, Michigan State University
Student Paper Awards:	Carolette Norwood, University of Cincinnati
Applied and Public Sociology:	Natalie Haber-Barker, Children's Memorial
Local Arrangements:	Barbara Denison, Shippensburg University
Publication Policy:	Kent Schwirian, The Ohio State University
Teaching Section:	Melinda Messineo, Ball State University
J. Milton Yinger Award:	Robert Shelby, Ohio University
Equity and Inclusion :	Robert Newby, Central Michigan University

NCSA Staff

Public Relations Coordinator:	Susan Alexander, Saint Mary's College
Conference Coordinator:	Joyce Lucke, Paragon Meeting & Events

A Special Thank You to the following for making the Pittsburgh conference a success:

- Dr. James Mike, Dean of the College of Arts & Sciences, Shippensburg University, Shippensburg PA
- Jeremy Goshorn, Graduate Admissions Office, Shippensburg University, Shippensburg PA
- Ph.D. program in Administration & Leadership Studies, Department of Sociology, Indiana University of Pennsylvania
- Army National Guard, Carlisle Barracks, Carlisle PA
- Department of Applied Socio-Behavioral Studies, Mansfield University, Mansfield PA
- Graduate Program in Sociology, Kenneth P. Dietrich School of Arts and Sciences, University of Pittsburgh, Pittsburgh PA
- Rural Sociological Society
- LSS Book Exhibit
- Barbara Jones Denison, Shippensburg University
- Jamie Miller, Convention Services Manager, Marriott City Center



Special Thank you to Routledge, Taylor & Francis Group
for supporting the 2012
Student Reception & conference lanyards





Political Renewal: Occupations, Springs, and Tea Parties

Daniel J. Myers

Professor of Sociology
Vice President and Associate Provost
University of Notre Dame

It was not long ago that I criticized social movement study for inventing novelty where it did not really exist. I wrote, “scholars have been waiting for, wanting, perhaps even panting after the next big change in how social movements operate...that something fundamental could be changing in how activists, protest, and, therefore, standard politics operate is an exciting prospect—and that we might be living through it, poised to record, study, and interpret it in contemporaneous relief, even more so.” Despite that desire, however, I concluded five years ago that things really hadn’t changed much—at least in terms of the implications for theory. But now, I think the time has finally come. Three recent mobilizations have provided us with something new to sink our collective teeth into. The Tea Party, the Arab Spring, and Occupy Wall Street represent changes in the motivations and tactics driving social and political change that can renew the study of protest and collective political influence. These three bursts of political behavior reveal important edges of social movement study and, at the same time, exhibit roots in the now classic ideas in the field.

Daniel J. Myers is Professor of Sociology, Vice President, and Associate Provost at the University of Notre Dame. His current research examines racial rioting in the 1960s and 1970s, deterministic and stochastic models of diffusion for collective violence, mathematical models of collective action, media coverage of protests, demonstrations, and riots, and game theoretic analyses of small group negotiation. He has published many books and articles primarily focused on social movements, the diffusion of social phenomena, social psychology, and urban politics. These include: *Toward a More Perfect Union: The Governance of Metropolitan America* (with Ralph Conant), *Social Psychology* (with John DeLamater), and *Identity Work in Social Movements* (with Jo Regger and Rachel Einwohner).

Myers has been particularly active in the social movements and collective behavior scholarly area, serving as the editor of *Mobilization* and founding the Center for the Study of Social Movements at Notre Dame which organizes the annual John D. McCarthy Lifetime Achievement Award and Distinguished Lecture, and the annual Young Scholars in Social Movements Conference.

Daniel has served as the Director of Faculty Development and Research in the Kroc Institute for International Peace Studies and then Associate Dean in the College of Arts and Letters, where he guided a rapid expansion of the social science division, the creation of the Center for Social Research, and strategic advances in the college’s research programs. A popular and innovative teacher who has been particularly active in leading undergraduate research, Myers has won the Rev. Charles E. Sheedy, C.S.C., Award for Excellence in Teaching—the College of Arts and Letters’ highest teaching honor.



MASTER'S IN SOCIOLOGY

Looking for a master of arts program in sociology that uses the very latest analytical and research skills to prepare you for professional employment or doctoral studies? Then find out what Ball State has to offer.

We're one of the few universities in the nation to offer our graduate students a certificate in the rapidly expanding field of institutional research. And our emphasis on research methods, research experience, and analytic skills provides excellent preparation to pursue a doctorate. In fact, many of our graduate students go on to doctoral and professional programs at some of the nation's top institutions.

ENGAGING CLASSES

In-depth courses in research, statistics, and theory with four elective track options:

- Institutional research certificate
- Teaching certificate
- Thesis
- Additional research courses

COMPETITIVE OPPORTUNITIES

Start a career in:

- Research
- Human resources
- Teaching
- Administration
- Government
- Nonprofit

COLLEGIAL RELATIONSHIPS

Small faculty-to-student ratio.
Faculty interests include:

- Family
- Inequality
- Education
- Health
- Religion
- Media and leisure
- Law
- Scholarship of teaching and learning

GREAT VALUE

- Assistantships available
- Housing stipends available
- Completion in two years or less



CONTACT: Rachel Kraus, graduate director, rmkraus@bsu.edu,
or visit us at www.bsu.edu/sociology.

CHALLENGE + OPPORTUNITY

87th Annual Meeting of the North Central Sociological Association



BOOK EXHIBIT



**ORGANIZED BY
THE LIBRARY OF SOCIAL SCIENCE**

This year's Annual Meeting of the North Central Sociological Association will feature a special book exhibit organized and managed by the LIBRARY OF SOCIAL SCIENCE. The exhibit will provide a comprehensive collection of the latest and most significant titles in the field and will contribute substantially to the excitement and intellectual value of our meeting. The book exhibit will be open throughout the conference. Please stop by early and often, say hello to book exhibit manager Mei Ha Chan—and browse to your heart's content. All books are on sale at special, discounted rates.

**The following are among the publishers
whose titles will be featured in the display:**

ABC-CLIO	Cornell U. Press	Lynne Rienner Publishers
U. of Alabama Press	Edwin Mellen Press	Polity Books
Bayou Publishing	Grey House Publishing	Potomac Books
Berghahn Books	Italian Paths of Culture	Routledge
Brill	ISBS	Rowman & Littlefield
U. of Chicago Press	Island Press	Rutgers U. Press
Cognella Academic Publishing	John Wiley & Sons	Transaction Publishers
Common Ground Publishing	Liturgical Press	World Scientific
	Living Justice Press	

For more information on LIBRARY OF SOCIAL SCIENCE BOOK EXHIBITS, please call Richard Klein at (718) 393-1075 or email LSSBookExhibits@earthlink.net.

THE BOOK EXHIBIT IS LOCATED IN BALLROOM 6

Great Things to Know for the Conference

Registration fees include entrance to all conference sessions, business meeting and Friday's evening reception

Sessions that are part of North Central Student Sociological Conference are indicated in the program with (NCSA) after the session title

In the schedule, workshops are indicated by (W) after the title and panels are indicated by (P)

The Friday Business meeting is open to all members

Buy your NCSA "dog tags" at the registration desk
limited quantity available onsite

The hotel offers a FREE shuttle service to two nearby entertainment districts where you will find numerous dining establishments of all price ranges

Present the coupons in your bag with your name badge for discounts at local attractions

Before you leave the conference, drop your name badge in the box at the registration desk
one badge will be drawn for \$15 credit on your 2012 membership dues

THURSDAY, APRIL 12**6:00pm—9:00pm**

Registration Desk

Grand Foyer A

6:00pm—10:00pm**ASE1 Old Council Meeting**

Presiding: Lawrence Nichols (West Virginia U)

City Center B

FRIDAY, APRIL 13**7:30am—3:00pm**

Presenter Preparation Room

Ballroom 1

7:30am—5:00pm

Registration Desk

Grand Foyer A

LSS Book Exhibit

Ballroom 6

8:00am—9:00am**B1.1 Families: Deviance and Inequalities**

Ballroom 3

Organizer: Michelle Bemiller (Walsh U)

Family Structure and Tobacco Use Among American 8th Graders, Josalie Condon (Kent State U)*The Noncustodial (M)other*, Michelle Bemiller (Walsh U)*Parenting Classes: Teaching the 'Right' Way to Parent*, Kathryn Jimenez (U of Cincinnati)**B1.2 History of Sociology**

Marquis B

Organizer: Lawrence Nichols (West Virginia U)

The "Harvard Approach" to Sociology: Constructing Local Paradigms of Science, 1926-1951, Lawrence Nichols (West Virginia U)*On the Necessity of Re-engaging the Classical Greek and Latin Literatures: Lessons from Emile Durkheim's The Evolution of Educational Thought*, Robert Prus (U of Waterloo)*Is the Park-Stonequest Theory Still Heuristic? The Concept of the Marginal Man from 1912 to 2012*, J.I. Hans Bakker (U of Guelph)**B1.3 Inequality in American Schools: Inequality, Violence, and Achievement**

City Center A

Organizer: Laci Fiala (Walsh U)

Using a Multi-Factor Measure of School Violence to Assess Educational Outcomes at the School Level, Lace Fiala (Walsh U)*Neighborhood Social Reproduction: An Analysis of Differential Achievement at the School District Level*, Quentin Kilpatrick (Ohio U)*Can Differences Between School Districts Explain the Race Gap in Achievement on the Ohio Graduation Test?*, Alexander Sinclair (Hiram C)*Juxtaposing Fatalism, Optimism, and Realism: How Low-Income Students Manage Decisions about Higher Education*, Danielle Lavin-Loucks (Valparaiso U)**B1.4 Putting Teaching to the Test (W)**

Ballroom 2

Organizer: Baranda Sawyers (Lansing Community C)

B1.5 Sexual Violence on Campus

Marquis C

Organizer: TBA

The Relationship Between Sexual Victimization and Fear, Monica Oliva (U of Akron)*Hooking Up: Hostile Environments and Higher Education*, Gillian Gualtieri (Kenyon C)

- B1.6 Teaching “The Wire”** Marquis A
 Organizer: Rachael Woldoff (West Virginia U)
Teaching a Sociology ‘The Wire’ Capstone in Pittsburgh, Rachael Woldoff (West Virginia U)
‘The Wire’ in Appalachia? A Graduate Student’s Experience, Sharad Patal (West Virginia U)
Learning about Pittsburgh through ‘The Wire:’ An Undergraduate Experience, Kelsie Conner (West Virginia U)
- B1.7 The Challenges of Care Work: Theory and Practice** Ballroom 4
 Organizer: Mary Tuominen (Denison U)
Health Care Access and Action Research: The Challenges of Empowerment in a Low-Income Community, Mary Tuominen (Denison U)
Emotional Labor in Gendered Occupations: The Case of the Female Funeral Director, Allison Pruitt (U of Louisville)
The Experiences of Adult Children and Parents’ Psychological Well-Being, Deidre Lynn Redmond (Indiana U)
- B1.8 Tips, Best Practices and Pitfalls to Avoid in Supervising Internships (W)** City Center B
 Organizers: Barbara Jones Denison (Shippensburg U) and Dane Lauber (Shippensburg U)
- 9:15am—10:45am**
- B2.1 Applied and Public Sociology** Marquis C
 Organizer: Natalie Haber-Barker (Northwestern U)
What Kind of Doctor Are You?: An Evaluation of Doing Research in a Pediatric Intensive Care Unit, Natalie Haber-Barker (Northwestern U)
Exploring the Feasibility of Quantifying the Relationship Between Corruption in Education and Economic Development in Central Asia, John Weidman (U of Pittsburgh)
Re-Entry Programs and Recidivism in the United States: A Fort Wayne Cohort Study, Jacob Perkins (Indiana U Purdue U Fort Wayne)
On Rural Sprawl and the Simulated: A Qualitative Study, Nicholas Weitzel (Western Carolina U)
- B2.2 Classical Sociological Theory and Contemporary Issues** Ballroom 2
 Organizer: Robert Carrothers (Ohio Northern U)
Time Capital: a Mediating Factor in the Intergenerational Transmission of Socioeconomic Status, Tommy Wayne Wornick (U of Texas at Dallas)
Interracial Adoption in the United States, Arielle House (Ohio Northern U)
Sociopaths and the Collective, Wade Thomas Boggs (Ohio Northern U)
Distracting the Gravediggers: Conflict Theory and the Lottery, Morgan Roddy (Ball State U)
- B2.3 Current Social Issues: Economy, Globalization, Class Bias in College Education, and the Changing Political Climate in the U.S.** City Center B
 Organizer: Fayyaz Hussain (Michigan State U)
Immigration and Education: The Wage Disparity between White and Asian Scientists, Phillip Broyles (Shippensburg U)
Immigration and Education: The Wage Disparity between White and Asian Scientists, Timothy Schock (Shippensburg U)
Social Capital as Collateral: Banking on the Poor, Esaya Bekele Geleta (U of Limerick, Ireland)
Attitudes of Business and Non-business Students Toward Corporate Social Responsibility, Anastasiia Kucher (West Virginia U)
Adjunct Faculty, Academic Freedom and the Changing Nature of Institutions of Higher Education, Harlan Schottenstein (Franklin U)
Setting Standards: Production Organization, Labor, and Inequality in Coffee and Clothing Global Value Chains, Caroline Arnold (Brooklyn C) and Anne Boatner (Brooklyn C)

- B2.4 Expectations, Attendance and Attainment in Higher Education** Ballroom 3
 Organizer: Lisa Hickman (Grand Valley State U)
Effects of Educational Expectations on College Attendance among Ethnic Minorities, Paul Anderson (U of Cincinnati)
Is College Worth It? That Depends on Who You Are: A Look at NSSE Outcomes, Stephanie Bennett (The C of St. Rose)
Penalized or Privileged?: Sexual Identity, Gender, and Postsecondary Educational Attainment, Leigh Fine (The Ohio State U)
College Attendance and the Role of Within-School and Within-Community Environmental Factors, Lora Phillips (Kent State U) and Aaron Rinehart (Kent State U)
- B2.5 Intersectional Notions of Family** Ballroom 4
 Organizer: TBA
The Effect Of Eurocentric Value Internalization on African American Male/Female Interpersonal Relationships, Megan Mitchell (Agnes Scott C)
Logics and Practices of Desperate Wartime Survival, Gender, Habitus, and Duty in the Blockade of Leningrad, Jeff Hass (U of Richmond)
Transnational Families: The Continuity of Family Ties and the Issue of Caregiving, Naoko Oyabu-Mathis (U of Mount Union), Aya Kimura-Ida (California State U-Sacramento) and Rina Fukushima (California State U-Sacramento)
Gender Role Attitudes & Health: Patterns of Smoking and Alcohol Consumption among Japanese Fathers, Yukha Maruyama (Kenyon C)
- B2.6 Men and Masculinities** Ballroom 5
 Organizer: Marci Cottingham (U of Akron)
Masculinities and Emotion: Theoretical and Methodological Issues in Research, Marci Cottingham (U of Akron)
Trans-masculinity and Narratives of Authenticity: A Content Analysis of Documentary Film (1997-2011), Austin Haney (Kent State U)
Social Awkwardness, Nerdism, and Manhood Acts in a Campus LARPing Group, James Martin (Indiana U of Pennsylvania) and Christian Vaccaro (Indiana U of Pennsylvania)
Fathers of Anarchy: Outlaws, Lawmen and Hegemonic Masculinity, Norm Conti (Duquesne U)
- B2.7 Qualitative Research Methods** Marquis B
 Organizer: Kathryn Feltey (U of Akron)
Qualitative Methods: Capturing the Behavioral Improvements of Participants in a Mood and Memory Intervention for Older Adults, Krystal Culler (U of Akron)
Internet Memes as Symbolic Interactions: Examining Emotion and Meaning in Online Space, Michael Steiner (U of Akron)
Identifying Issues with First Year Teaching Assistants Utilizing a Multiple Field Approach, Ruth Walker (U of Akron)
Always a Laughing Matter: Qualitative Approaches to Understanding Deviant Identity Construction Among Clowns, Robyn White (Cuyahoga Community C)
Understanding the Construction of Authenticity in a 'Working' Cover Band, Terry Mortensen (Kent State U)
- B2.8 Sociology Issues for Faculty** Marquis A
 Organizer: Leslie Elrod (U of Cincinnati)
Beyond the Lecture: Successfully Navigating Service and Professional Development in the Two-Year College, Leslie Elrod (U of Cincinnati)
The Community College Cache: Turning 'Undecided' Students into Sociology Majors, Betsy Ross (Baldwin Wallace C)
Meaningful Grading Strategies that Save Time, Melinda Messineo (Ball State U)
Engaging the Masses: Teaching and Learning in Two-year Colleges, Leslie Elrod (U of Cincinnati)

11:00am—12:00pm

- B3.1 Fun and Games in Teaching Sociology (W)** Marquis B
Organizer: Lynn Ritchey (U of Cincinnati-Blue Ash)
Panelists: Bernadette Dietz (U of Cincinnati) and Leslie Elrod (U of Cincinnati)
- B3.2 Navigating the Job Market (W)** Marquis C
Organizer: Melinda Messineo (Ball State U)
- B3.3 Queer Understandings of Parenthood (P)** Ballroom 4
Organizer: Scarlett Stack (U of Cincinnati)
- B3.4 Peace & War** Ballroom 3
Organizer: Julie Hart (Ohio Dominican U) and Todd Callais (Independent Scholar)
Changing Sides: Stigma Management Techniques for Anti-War Veterans, Julie Hart (Ohio Dominican U) and Todd Callais (Independent Scholar)
Economic Strain and Political Violence: Applying Social Strain Theory to Terrorism, Reinmar Freis-Beattie (West Virginia U)
- B3.5 Race & (Post-Racial) Structure** Ballroom 5
Organizer: Baranda Sawyers (Lansing Community C)
Racial Microaggressions and Oblique Generic Hegemonic Processes, Kemal Faruquee (Pennsylvania State U)
The Effects of Eurocentric Value Internalization on African American Male/Female Interpersonal Relationships, Megan Mitchell (Agnes Scott C)
But Aren't We All Poor?: How Economics Influence Racial Attitudes in Michigan, Paula Miller (Michigan State U)
- B3.6 Sociology of the Body** Ballroom 2
Organizer: Jennifer Carter (U of Cincinnati)
Is it supposed to fit like that? Protecting the Body in Women's Tackle Football, Jennifer Carter (U of Cincinnati)
Mommy Makeovers: A Content Analysis of Cosmetic Surgery's Role in Exacerbating the Divide between the Sexual and the Maternal, Jodi Stooksberry (U of Cincinnati)
Gendered Embodiment Cycles in Mixed Martial Arts, Christian Vaccaro (Indiana U of Pennsylvania)
- B3.7 Teaching Large Classes: Innovative Methods** Marquis A
Organizer: Fayyaz Hussain (Michigan State U)
Use of Clickers and Undergraduate Learning Assistants (ULA) and Its Impact on Student Learning in Large Classes, Fayyaz Hussain (Michigan State U)
Teaching Innovations in the Classroom: First Person Accounts from Undergraduate Learning Assistants, Sara Janos (Michigan State U) and Liz McKinely (Michigan State U)
Making Theory Relevant: A Team-Based Learning Approach to Criminology, Rachel Stein (West Virginia U)
- B3.8 The Role of Codes of Ethics and Professional Ethics Enforcement in NCSA (P)** City Center B
Organizer: Jean Shin (American Sociological Association)
Panelists: Kathleen Blee (U of Pittsburgh), Sally Hillsman (American Sociological Association), Thomas Van Valey (Western Michigan U)

12:45pm—2:00pm

- B4.1 Media, Technology, and Society I** Marquis C
Organizer: Robert Shelby (U of Louisville)
Ever Changing Love for a Modern World: A Content Analysis of Gender Differences and Changes in Relationships in US Romantic Dramas, Katherine Heeb (Texas A&M U-Corpus Christi)
I am Gold Coast Royalty and My Daughter Will Be Too: The Social Construction of Beauty and Mothering on Toddlers & Tiaras, Jessica Sullivan (Western Michigan U) and Lisa Marie Kruse (Western Michigan U)

B4.1 cont.....Media, Technology, and Society I

From My Living Room to Yours: A Grounded Theory Typology of Racial Discussions on YouTube, Russell Spiker (U of Cincinnati)
 The Demotivating Effect of Media on Obese and Overweight Individuals from a Cultivation Theory Perspective, Christopher Wisecup (U of Louisville)

1:00pm—2:00pm**B5.1 Being the Diversity in the Academy: The Challenges and Opportunities (P)**

Ballroom 5

Organizer: Shelytia Cocroft (Wayne State U)

B5.2 Criminology Round-Up

Marquis A

Organizer: Shelly McGrath (U of Alabama)

Predicting Firearm Use in Texas Homicides among White, Black, and Latino Perpetrators: Towards a Logistic Regression Model, Daniel Gutierrez (Indiana U Purdue U Fort Wayne) and Elaina Johns-Wolfe (Indiana U Purdue U Fort Wayne)

Old Dogs and New Tricks: Correctional and Societal Issues Concerning Reintegration and the Aging Prison Population, Eric Jorrey (The Ohio State U)

Brokering Delinquent Networks: Spanning the Micro-Macro Divide in Delinquency Research, Christopher Keenan (The Ohio State U)

Renewing our Perspectives on Women and Crime Topics in Criminology: Implications for the Future of Diversity in Criminology, Patricia Lomire (Minot State U)

Perceptions of Criminality, Marshall Schmidt (West Virginia U)

The Social Life of Young Drug Dealers: A Longitudinal Analysis of Drug Trafficking, Social Relationships, and Violence, Patrick Seffrin (Marywood U)

B5.3 Racial and Ethnic Identities I

Ballroom 2

Organizer: Leslie T.C. Wang (Saint Mary's C)

Admiration and Fear: How Race and Class Impact Public Understanding of Organized Crime in Popular Television, Liz Dickson (Ohio Dominican U) and September Edwards (Ohio Dominican U)

Black and White Interpretations of Racial and Ethnic Comedy, Aaryn Green (U of Cincinnati)

B5.4 Peer Review of Teaching (W)

Ballroom 4

Organizer: Kristin Park (Westminster C, Pennsylvania)

B5.5 Social Policy Issues

City Center B

Organizer: Frances Shupe (U of Louisville)

Women in Combat: Challenging the U.S. Army's Policy of Exclusion, Katherine Barnes (U of Louisville)

Student Financial Aid Policy and Student Debt: A Cry for Reform, Henry Curtis (U of Louisville)

Practices and Policies that Help or Hinder Refugee Adjustment to Life in US: Case Study-Louisville Metro, Muhamed Fazlagic (U of Louisville)

Interpreting Cultural Values in Public Policy: An Examination of Title III in the No Child Left Behind Act, Casey Griffith (U of Louisville)

Who Polices the Police? A Look at Civilian Oversight of Police, Michael Littrell (U of Louisville)

Effectively Utilizing Metro Park Property for the Improvement of Louisville's Communities via the Riding Spot Network, Shane Scott (U of Louisville)

Asset Building through Individual Development Accounts, Frances Shupe (U of Louisville)

B5.6 Sociology and Social Liberation (P)

Ballroom 3

Organizer: James Paharik (Seton Hill U)

Panelists: Susan Eichenberger (Lansing Community C), James Paharik (Seton Hill U) and Marie Skoczylas (U of Pittsburgh)

- B5.7 Urban Sociology** Marquis B
 Organizer: Natalie Haber-Barker (Northwestern U)
Pennsylvania Main Street Programs: Understanding the Strengths and Weaknesses of Downtown Revitalization, Chad Kimmel (Shippensburg U)
Social Media and Social Movements, Jo Anna Kelly (Walsh U) and Kim Metz (Walsh U)
Selling Fracking: Methods of Legitimation Employed by the Natural Gas Industry in the Marcellus Shale Region, Jacob Matz (West Virginia U)
Process as Product: Making Sustainable Farmers' Work Visible and Viable in the Local Market, Johanna Klotz (Chatham U)
Religious Benevolence as Positive Deviance: Culture Conflict in Secular and Religious Norms, Matthew Lee (U of Akron)

2:15pm—3:15pm

- B6.1 Enabling and Promoting Creativity in Sociology Courses: Alternative to the Traditional Research Paper (W)** Ballroom 4
 Organizer: Jessica Leveto (Kent State U)
 Panelists: Alex Briesacher (Kent State U), Erika Briesacher (Kent State U) and Chivon Fitch (Kent State U)
- B6.2 Media, Technology, and Society II** Marquis C
 Organizer: Robert Shelby (U of Louisville)
Online Commitment, Real World Participation, Simon Purdy (Western Michigan U)
Texting Teens: The Competing Claims about Youth in the Arizona Text Messaging While Driving Debate, Amanda Marie Smith (Western Michigan U)
An Examination of Digital Pirates Techniques of Neutralization, Chris Davies (West Virginia U)
United States Emerging Technology Policy: Balancing Human and Economic Health through Well-Being, Robert Shelby (U of Louisville)
- B6.3 Social Construction of Masculinities** Ballroom 5
 Organizer: Susan Alexander (Saint Mary's C)
The Male Masquerade: Constructing Masculinity through Halloween Costumes, Susan Alexander (Saint Mary's C)
Unapologetically Male: SPIKE TV and the Construction of Masculinity, Melinda Messineo (Ball State U)
Defining and Asserting Masculinity through a Locally Based Conceptualization of Class, Angel Stough-Hunter (The Ohio State U)
- B6.4 Sociological Video: Social Issues Explored Digitally (W)** Ballroom 2
 Organizer: David Tabachnick (Muskingum U)
Occupy and the Corporate Form, Steve McGuire (Muskingum U)
A Boxed Life: Reactions to the Homeless in Pittsburgh and Columbus, Chelsea Christy (Muskingum U)
The Culture of Coal: A Look at the Life and Heritage of the West Virginia Coal Miner, Ryan Kreiter (Muskingum U)
- B6.5 Racial and Ethnic Identities II** Ballroom 3
 Organizer: Leslie T.C. Wang (Saint Mary's C)
The 1.5 Generation: Gender and Class Differences among Chinese American Adults, Leslie T.C. Wang (Saint Mary's C)
The Effects of Socially Constructed Ethnicity Among Bosnian Refugees Living in US in Ethnically Mixed Marriages, Muhamed Fazlagic (U of Louisville)
What are You Anyway?: Understanding The Racial and Ethnic Identities of Caribbean Blacks in the U.S., Caralee Jones (Indiana U) and Christy Erving (Indiana U)

3:45pm—4:45pm

- B7.1 Navigating the Promotion and Tenure Process** Marquis C
 Organizer: Melinda Messineo (Ball State U)

- B7.2 Incorporating Rural-Urban Sensitivity in Introductory Sociology Courses (W)** Ballroom 5
 Organizer: Jennifer Steele (West Virginia U)
 Panelists: Jennifer Steele (West Virginia U), Anjel Stough-Hunter (The Ohio State U) and Mauricia John (The Ohio State U)
- B7.3 Plagues, Epidemics, and Contagions** Ballroom 4
 Organizer: Kent Schwirian (The Ohio State U)
The Political Ecology of Infectious Diseases: Pneumonic Plague in Surat, India (1994) and Cholera in Port au Prince, Haiti (2010), Kent Schwirian (The Ohio State U)
The Political Partisan Dimensions of Swine Flu Vaccination, Gustavo Mesch (U of Haifa, Israel) and Kent Schwirian (The Ohio State U)
HIV Prevention and Condom Use Among African American Women College Students, Carollette Norwood (U of Cincinnati)
What Has Changed Since the 1980s? Content Analysis of HIV/AIDS News in Indonesian Mass Media from 1983 to 2010, Ulyy Putri (U of Colorado-Boulder)
- B7.4 Politics, Crime, and the Legal System** Ballroom 3
 Organizer: Chad Malone (The Ohio State U)
Two Tickets to the Gun Show: Utilitarian and Non-Utilitarian Motivations for Firearm Attainment, Martin Kosla (The Ohio State U) and Trent Steidley (The Ohio State U)
Decision Time: Foundations of Juvenile Court Judges' Disposition Decisions, Brian Smith (Central Michigan U)
- B7.5 Researching Vulnerable Populations** Marquis B
 Organizer: Meghan Novisky (Kent State U)
Cutting Through the Razor Wire: Challenges Conducting Research with Prisoners, Rebecca Bordt (DePauw U)
Inequality in Prison: A Look into Women in Prison, Ryan Sommerkorn (West Virginia U)
Research with LGBTQ Population: Overcoming Barriers to Gaining Access and Building Trust, Terra Howell (U of Akron)
- B7.6 Teaching Criminology** Marquis A
 Organizer: Bill Tregea (Adrain C)
Educational Videos for Teaching Juvenile Justice, Scott Desmond (IUPUI)
Teaching Criminology: Using Students' Camera Phones to Illustrate CPTED, Chris Huggins (U of Kentucky)
Mentoring Students in Independent Study Courses Designed to Familiarize Students with the Methods of Social Research, Janice Proctor (The Ohio State U Eastern Campus)
- B7.7 Scholarly Achievement Award Presentation** City Center B
 Organizer: Steve Scanlan (The Ohio State U)
For the Family? How Class and Gender Shape Women's Work, Sarah Damaske (Pennsylvania State U)
- BSE1 Community College Meet & Greet** Ballroom 2
 Host: Leslie Elrod (U of Cincinnati)
- 3:45pm—5:00pm**
- BSE2 NCSA Student Welcome Reception,** Ballroom 1
Sponsored by Routledge (Taylor & Francis Group), publishers of *Sociological Focus*
 Host: Gail McGuire (Indiana U Southwest)

5:00pm—5:30pm

BSE3 NCSA Annual Business Meeting Ballroom 5
Presiding: Lawrence Nichols (West Virginia U)

5:30pm—6:00pm

BSE4 NCSA Award Ceremony Ballroom 5
Presiding: Lawrence Nichols (West Virginia U)

6:00pm—7:15pm

BSE5 The John and Ruth Useem Plenary Address Ballroom 5
Introduction by Steve Carlton-Ford (U of Cincinnati)
Political Renewal: Occupations, Springs, and Tea Parties, Daniel Myers (U of Notre Dame)

7:00pm—8:15pm

BSE6 The NCSA Presidential Reception, sponsored by the Useem Family Fund and Sociological Focus Grand Foyer A
Hosts: Lawrence Nichols (West Virginia U) and Steve Carlton-Ford (U of Cincinnati)

SATURDAY, APRIL 14

7:30am—5:00pm

Registration Desk Grand Foyer A

7:30am—6:00pm

Presenter Preparation Room Ballroom 1

LSS Book Display Ballroom 6

7:15am—8:00am

CSE1 Teaching Section Meeting with Continental Breakfast City Center A
Presiding: Melinda Messineo (Ball State University)

8:00am—9:30am

C1.1 Animals and Society Ballroom 3
Organizer: Paul Becker (U of Dayton)
Toward a Theory of Animal Welfare: Comparing Conflict Perspectives with Public Attitudes toward Animal and Worker Well-Being in the Food Sector, Danielle Deemer (The Ohio State U)
Are Scapegoats an Invasive Species Too? Understanding the Socioeconomic Construction of Invasive Species, Christina Leshko (Michigan State U)
Media Dog: A Content Analysis of the Media's Portrayal of Service Dogs, Rebecca Stevens (West Virginia U)
Give Me Shelter: The State of Animal Sheltering in County & Municipal Shelter in Kentucky, Jennifer Blevins Sinski (U of Louisville)

C1.2 Modern Sociological Theory and Contemporary Issues Ballroom 2
Organizer: Robert Carrothers (Ohio Northern U)
Only in Vancouver: A Value-Added Analysis of the 2011 Vancouver Hockey Riot, Robert Carrothers (Ohio Northern U) and Jerry Lewis (Kent State U)
The Impact of Karl Mannheim on C. Wright Mills: The Role of Reason and the Question of Freedom, Kenneth Eslinger (John Carroll U)
Consumption as a Social Problem or Means for Social Change?, Wendy Wiedenhoft Murphy (John Carroll U)
Addressing Development as an Objective Consumable: an Autoethnography, Nicholas Weitzel (Western Carolina U)

FRIDAY

SATURDAY

- C1.3 Population Issues** Marquis A
 Organizer: Elias Nigem (U of Toledo)
Well-being and Risk Perceptions of Mothers in Kyiv, Ukraine: A Two-Wave Panel Data Analysis, Ying Liang (Kent State U) and Richard Adams (Kent State U)
Assessment of Three Methodological Changes to the Measurement of Preterm Birth Rates in the Typical Study Procedures of Research Using Vital Statistics Birth Records, Rebecca Reeder (U of Cincinnati) and P. Neal Ritchey (U of Cincinnati)
Militarization and Fertility: Recasting the Demographic Transition Theory, Muhammed Asadi (Southern Illinois U-Carbondale)
Iraqi Refugees and the Ethnic Enclave Debate: A Study of the Labor Force Activity of Iraqi Refugees by Resettlement Location and Gender, Alicia Lee (U of Pennsylvania)
Barriers to the American Dream: Community Responses to Poverty, Sharon Lindhorst Everhardt (Lourdes U) and Barbara Chesney (U of Toledo)
- C1.4 Social Movement Activism: Responses and Involvement in Collective Efforts at Social Change** Ballroom 5
 Organizer: Eric Swank (Morehead State U)
An Intersectional Analysis of Gay and Lesbian Activism, Eric Swank (Morehead U) and Breanne Fahs (Arizona State U)
An Exploration of Business-Targeted Collective Action, Lisa Neilson (The Ohio State U)
Using 'Time' to Achieve Social Justice: Exploring Time Banking as a Community-Building, Social Justice Initiative, Chad Kimmel (Shippensburg U)
The Good, the True, and the Rhetoric of Movements: Framing Legitimacy and Normality, Jeffrey Hass (U of Richmond) and Irene Petten (Columbus State Community C)
- C1.5 Teaching Sociology** City Center A
 Organizer: Kathryn Feltey (U of Akron)
Barriers to Student Learning, Michelle Bemiller (Walsh U), Kathryn Feltey (U of Akron) and Rachel Schneider (U of Akron)
Innovative Strategies for Teaching Honors Social Problems, Robyn White (Cuyahoga Community C)
Moving Students to Action: Methods of Engaging Students in the Community and the Profession, Michelle Smith (Lakeland Community College) and Stephen Keto (Kent State U)
Making It Real: Introducing Sociology to First Year Students, Michelle Smith (Lakeland Community C)
 Pedagogy Inside-Out: Teaching Undergraduates in Prison, Norman Conti (Duquesne U), Rebecca Katz (Morehead State U), James Nolan (West Virginia U), Jeri Kerbi (West Virginia U), Katie Pantaleo (Lock Haven U), and Linda Morrison (Duquesne U)
- C1.6 Gender I (NCSSC)** Marquis B
 Moderator: TBA
Fear and Discrimination: Medical Professionals and Transgender Patient Complications, Stephanie Foreman (Indiana U-South Bend)
Gender Regimes and Employment Commitment: A Cross-National Comparison Across Twenty-Two Countries, Shibashis Mukherjee (Indiana U)
Body Objectification at Fraternity Houses: An Examination of the Social and Environmental Settings, Cassandra Seaman (Westminster C)
To Serve All Mankind: How Women in Graduate Chapters of a Black Greek Letter Organization Balance Work, Family, and Civic Engagement, Aisha Upton (Ohio U)
We Gender Everything: Why Is(n't) Halloween Different?, Robyn Black (Indiana U-South Bend)
- C1.7 Media & Texts (NCSSC)** Marquis C
 Moderator: Linda Burns (Carlow U)
What Can You See? A Cross-Cultural Frame Analysis of Visual Depictions of the Great East Japan Earthquake, Kayla Potter (Wittenberg U)
Stories from the Near East: Learning about Culture through Letter Writing, Anne Jamieson (Hope C)

C1.7 cont...Media & Texts (NCSSC)

Social Class and the Standardization of English Speech in Late Eighteenth-Century English Novels, Hannah Stowe (Indiana U-South Bend)

Demographics and the Utilization of Social Media, Alyssa Smith (Carlow U)

El Paraiso del Traficante: A Content Analysis of Music Lyrics in Narcocorridos, Mariela Aguilera (Saint Mary's C)

C1.8 Human-Animal Interaction (NCSSC)

City Center B

Moderator: David Blouin (Indiana U-South Bend)

Entertainment versus Enlightenment: A Social Analysis of Zoos in the United States, Maisie Fraley (West Virginia University)

Evaluation of Human-Pet Attachment Based on Gender, Cayla Grodotzke (Washington & Jefferson C), Adam Dominick (Washington & Jefferson C), Emma Shebest (Washington & Jefferson C)

Human-Animal Relations: Incongruities in Self-Reported Perceptions, Brandon Heckman (Washington & Jefferson College)

People and Pets: Exploring Levels of Support Gained from Dogs vs. Cats, Samantha Barclay (Washington & Jefferson C) and Zachary Hare (Washington & Jefferson C)

People and Pets: Past vs. Present Owners, Zachary DeCicco (Washington & Jefferson C) and Jared Jankowski (Washington & Jefferson C)

C1.9 Sociology of Religion

Ballroom 4

Organizer: Christopher Bradley (Indiana U Purdue U Fort Wayne)

The Interconnections Between Religious Evangelicalism, Spirituality and the Four Dimensions of Empathy, Christopher Bradley (Indiana U Purdue U Fort Wayne), Jeffrey Gruettert (Indiana U Purdue U Fort Wayne), Glenn Schnelker (Indiana U Purdue U Fort Wayne) and Vanessa Sampsel (Indiana U Purdue U Fort Wayne)

Understanding Death and the Evolution of Death Rituals: How Societies Deal with Issues Related to Death, Kisholisile Nyoni (Indiana U-South Bend)

Socialization in Chinese Academic Immigrants' Conversion to Christianity, Zhan Jiang (U of Louisville)
'Otherworldliness': Spirituality and Deviance in the Lives of Young Hispanic Adults, Adriana Garci (U of Notre Dame)

9:45am—10:45am**C2.1 New Frontiers in Sociology: Forensic Science and the Law (W)**

City Center B

Organizer: Duane Dukes (John Carroll U)

C2.2 John F. Schanbel Distinguished Contributions to Teaching Award 2011 Recipient Presentation

City Center A

Presiding: Melinda Messineo (Ball State U)

Becoming a Student Whisperer, Lynn Ritchey (U of Cincinnati-Blue Ash C)

9:45am-11:00am**C3.1 Sexuality & Intimate Relationships (NCSSC)**

Marquis B

Moderator: Fareeda Griffith (Denison U)

Interracial Relationships: Acceptance and Involvement amongst College-Aged Students, Anna Marie Hammersmith (Denison University)

The Sexual Attitudes and Behaviors of the College Student, Katrina M. Falconer (Westminster C)

How Has the Internet Affected Sexuality in America?, Nikkole Caudill (Indiana U-South Bend)

C3.2 Abuse in Families (NCSSC)

Marquis C

Moderator: Kristenne M. Robison (Westminster C)

Emotional Child Abuse: The Invisible Destroyer, Rori Peterson (Indiana U-South Bend)

Intimate Partner Abuse: Men, the Silent Victims in a Changing Society, Veronica Berning (C of Mount St. Joseph)

C3.2 cont....Abuse in Families (NCSSC)

The "Sheltered" Family: Tensions Surrounding Family Life in a Homeless Shelter, Jessica Wilson (Denison U)

Matrifocal Ties and Economic Abuse: Prevalence of Economic Abuse amongst Kinships in Ghana, Hannah Furnas (U of Akron)

9:45am—11:15am**C4.1 Globalization: Theorizing, Measuring and Assessing the Changing Dynamics of Global Cities**

Marquis A

Organizer: Brendan Mullan (Michigan State U)

Ranking Global Cities: What Counts?, Brendan Mullan (Michigan State U)

Types of Hub Cities and Their Effects on Urban Creative Economies, Zachary Neal (Michigan State U)

Competing Globally Through Public Art: Insights from New Orleans and Montreal, Toby Ten Eyck (Michigan State U), Brette Fischer (Michigan State U)

Athens, Greece: A Case Study in Crisis and Chaos, Sophia Koufopoulou (U of Crete, Greece)

C4.2 Health and Society

Ballroom 4

Organizer: Rebecca Brooks (Ohio Northern U)

Sugar is Sugar: The Media Reframing of High-Fructose Corn Syrup, Rebecca Brooks (Ohio Northern U)

Minority Status and the Search for Health Information: A Test of the Social Diversification Hypothesis, Gustavo Mesch (U of Haifa, Israel)

Health and Stress Among the Elderly in Kuwait Society, Yagoub Yousif Al-Kandari (Kuwait U)

Rugayah: An Islamic Methods of Healing and Treatment in Kuwait, Yousef Ali (Kuwait U)

Societal Influence on the Development of Alcoholism, Amber Betony Reamy (Ohio Northern U)

C4.3 Social Process and Building of the Social Self

Ballroom 3

Organizer: Patricia Case (U of Toledo)

Building Moral Selves through Helping Others: The Socialization of Service among Evangelical Christians, Allison DiBianca Fasoli (U of Chicago)

The Special Case of Oration: Salience of Setting and its Effect on Source Credibility, R. Paul Gray IV (U of Iowa)

Analysis of Voter Turnout and Motivations that Trigger Their Behavior, Sharad Patel (West Virginia U)

Body Modification's Progression Toward a Non-Deviant Identity, Irene Petten (Columbus State Community C)

9:45am—11:45am**C5.1 Race and Inequality**

Ballroom 2

Organizer: David Purcell (Kent State U)

Curating Inequality: The Link Between Cultural Reproduction and Race in the Visual Arts, Andria Blackwood (Kent State U)

The Relationship Between the Personal Attitudes of European-Americans Regarding Societal Equality and Feelings Towards Marginalized Populations, Lori Hale (U of Akron) and Monica Oliva (U of Akron)

An Analysis of How Class Matters among Second-Generation Caribbean Immigrants from Haiti, Cuba and Dominican Republic, Mauricia John (The Ohio State U)

Racial Ideology: Approaches to and Applications of the Concept in Recent Social and Behavioral Research, Michael Rosino (U of Cincinnati)

Selective Representation of Missing Children Stories in National News Media, Clara Simmons (West Virginia U)

Perceptions Shaping Reality: Examining the Cultural Roots of Negative Attitudes and Behavior Toward Poor Black Male Youth in Rio de Janeiro, Brazil, Andrew Mozdy (U of Pittsburgh)

C5.2 Sexuality and Gender

Ballroom 5

Organizer: Wanda McCarthy (U of Cincinnati)

A Closer Examination of Sexual Violence in Heterosexual and Lesbian Relationships, Wanda McCarthy (U of Cincinnati)

C5.2 cont....Sexuality and Gender

Religiosity Influences on Sexual Attitudes and Behaviors Among Young Christian Women, Cheri Ellefson-Terhune (Ball State U)

The Woman Who Looks Straight But has Self-Esteem: How to Spot a Bisexual, Julie Hartman (Frostburg State U)

The Climate for Women on Campus: Students' Views About and Experiences with Gender Issues, Mary Senter (Central Michigan U) and Cody Wright (Central Michigan U)

Parent-Child Communication and Its Effects on Adolescent Sexual Behavior, Lindsey Gordon (West Virginia U)

What My Body's Worth: Achieving the American Dream in the Backseat of a Car, Mary Dwyer (West Virginia U)

11:00am—12:00pm**C6.1 Choosing a Graduate School Program (P)** City Center B

Organizer: Rachel Kraus (Ball State U)

Panelists: Jennifer Carter (U of Cincinnati), Rebecca Erickson (U of Akron), Annulla Linders (U of Cincinnati), Morgan Roddy (Ball State U) and Cheri Ellefson-Terhune (Ball State U)

C6.2 Student Paper Competition Winner Presentations City Center A

Organizer: Carollette Norwood (U of Cincinnati)

Winners to be announced Friday at the NCSA Award Ceremony

11:15am—12:15pm**C7.1 Social Movements and Activism (NCSSC)** Marquis B

Moderator: Kristin Park (Westminster C)

A Marxian Critique of Legal Aid, Shuangqi (Joy) Wang (Denison U)

Applied Marxism: Critiquing the Past to Move Toward a Modern Revolutionary Praxis, Abberley Sorg (U of Toledo)

Is the Personal Political Enough? An Examination of Third Wave Feminism, Katharine O'Hara (Kenyon C)

C7.2 Preventing, Having and Feeding Babies (NCSSC) Marquis C

Moderator: Mary Tuominen (Denison U)

Gendered Contraceptive Choices and College-Aged Individuals: An Intersectional Analysis, Gillian Gualtieri (Kenyon C)

Cesarean Section Rates in the United States: How Anthropology Can Contribute to the Conversation, Bridget McGann (Indiana U-South Bend)

The Battlefield of Breastfeeding, Caitlyn Battaglia (Denison U)

11:30am—12:00pm**C8.1 Teaching as Social Activism** Marquis A

Organizer: Todd Callais (Independent Scholar)

Research Based Student Activism: Making the case for an LGBTQ Resource Center, Susan Alexander (Saint Mary's C)

Standpoint Epistemology as a Survival Tool for Instructing Black Males--Navigating Racial Transgression While Doing Race at a Sociological Conference: Welcome to Cleveland Nig\$#@, Calvin DaRonne Harvell (Henry Ford Community C)

12:00pm—1:00pm**CSE2 2012 NCSA Presidential Address** Ballroom 5

Introduction by Joel Best (U of Delaware)

Renewing Sociology: Integral Science, Solidarity and Loving Kindness, Lawrence Nichols (West Virginia U)

1:00pm—2:30pm**C9.1 Issues of Gender and Power**

Marquis A

Organizer: Maggie Stone (U of Louisville)

Turning the Tables?: An Examination into The Bachelorette and the Quest for a Fairy Tale Romance, Cody Wedge (Western Michigan U) and Lisa Marie Kruse (Western Michigan U)*Gender and Race: Workplace Control of American Workers*, Ying Yang (Shippensburg U)*A Study on Fraternity Men, Hyper-Masculinity and Homophobia: How West Chester University's Environment Equates*, Rebekah Balmer (West Chester U)*This Could be a Good Avenue for You: Influential Strategies in the Hiring of Strippers*, Maggie Stone (U of Louisville)**C9.2 Gender II (NCSSC)**

Marquis B

Moderator: Mary Ellen Batiuk (Wilmington C of Ohio)

Do Women Desire Marriage and Family More Than Men?, Shelby Zornes (Wilmington C of Ohio)*A Sociological Evaluation of Gender Roles and Media Depiction of Women Who Kill Their Children*, Niesha McGhee (Indiana U-South Bend)*Roller Derby and Gender Biases: What Can a Woman Really Do in Sports?*, Rachel Berryman (Indiana U-South Bend)*Division III Coaches' Perceptions of Gender Inequality*, Jordan Dunn (Westminster C)*Sex for Women by the Book*, Jasmine Comer (Indiana U-South Bend)**C9.3 Education (NCSSC)**

Marquis C

Moderator: Fareeda Griffith (Denison U)

The Imagined West: Study Abroad and Perceived Class Mobility among Chinese Students, Dingyi (Alfie) Wu (Denison U)*The Role of Education in Conflict Development, Resolution, and Prevention: Lessons from Northern Ireland, South Africa, and the United States*, Mary (Meg) Gaertner (Denison U)*Academic Success in College: The Effects of Social Skills on Grade Point Average between Males and Females*, Courtney Ann Gummo (U of Pittsburgh)*Eliminating the Gender Gap: Research into Past and Present Achievement Levels Between Students of Washington & Jefferson College*, Michael Prinkey (Washington & Jefferson C) and Jessica Fleck (Washington & Jefferson C)*College Students: Poor Sleep and Academic Performance*, Kristen Finkbeiner (Wilmington C of Ohio)**C9.4 Exploring Ideas in the Sociology of Education**

Ballroom 2

Organizer: Lisa Hickman (Grand Valley State U)

The Role of Teaching English as a Foreign Language in a Global Society: From an Analysis of Students' Perceptions of the Domestic Diversity and English Learning in Japan, Mieko Yamada (Indiana U Purdue U Fort Wayne)*College for Thinkers Versus College for Dummies*, Lynn Ritchey (U of Cincinnati-Blue Ash C) and Sarah Cummins-Sebree (U of Cincinnati-Blue Ash C)*Black Spaces at White Institutions: Examining the Black Campus Community as a Source of Social Support for African American Students at Predominately White Institutions*, Ciera Graham (U of Cincinnati)*Assessment of Ethical Disposition and Behaviors among U.S. College Students using an Adapted Multidimensional Ethics Scale*, Adam Perzynski (Case Western Reserve U), Joshua Terchek (Case Western Reserve U), Ellen Alexander (Case Western Reserve U), Anna Czekaj (Case Western Reserve U), Mikala Osani (Case Western Reserve U), Scott Tillman (Case Western Reserve U) and Nicole Deming (Case Western Reserve U)**C9.5 Conflict and Political Change in the Developing World**

Ballroom 3

Organizer: Robert Anthony (The Ohio State U)

The Conflict Trap: The Impact of War on Poverty, Underdevelopment, and Social Change, Stephen Scanlan (The Ohio State U)*Routine Activities Theory and Its Impact on One's Perceived Risk of Victimization: A Cross-National Analysis*, Shelly McGrath (U of Alabama) and Jessica Abbott (Thiel C)

- C9.5 cont....Conflict and Political Change in the Developing World**
The Prospect of the Arab Spring: Religion and Development of Democracy in the Middle East, Ahmad Khalili (Slippery Rock U)
Enough Already: A Preliminary Assessment of Dodd-Frank and the Control of Conflict Materials, Richard Clark (John Carroll U)

- C9.6 Framing Social Issues** Ballroom 5
 Organizer: Annulla Linders (U of Cincinnati)
The Institution of Tipping as a Source of Employee Agency: The Case of Restaurant Servers, Zachary Brewster (Wayne State U) and Jeremiah Wills (Queens U)
Folk Devils and 9/11: Media Frames in the New War on Terror, Derek Hesseling (Ohio Dominican U)
Everybody Around Here is From Some Place Else: News Frames and Hegemonic Discourses in the Immigration Debates in the United States, 2006 and 2010, Sharon Madriaga Quinsaot (U of Pittsburgh)
The Dirty Work of Poker: Impression Management and Identity, Marcus Vines (U of Cincinnati)

- C9.7 Self, Identity, and Social Inequality** City Center A
 Organizer: Lindsey Ayers (Kent State U) and Sarah Samblanet (Kent State U)
Adolescents & Illicit Drug Use: Examining How Self-Efficacy and Family Structure Play a Role in Marijuana Use, Amber Hunter (Kent State U)
Contact and Heterosexuals' Attitudes toward Same-Sex Couples: Results from a National Survey-Experiment, Annalise Loehr (Indiana U)
Reducing Racial Inequality in Task Groups: Exploring the Effects of Time and Transfer, Bobbi Reidinger (Kent State U), Lora Phillips (Kent State U) and Carla Goar (Kent State U)

- C9.8 Innovative Teaching in Sociology Classrooms: Simulations, Cooperative Learning, and Case Studies** City Center B
 Organizer: Mark Killian (U of Cincinnati)
Team-Based Learning in an Introductory Sociology Class, Mark Killian (U of Cincinnati) and Bastas Hara (U of Cincinnati-Blue Ash C)
The Simulated Society in Social Problems: Failure, Success, or Both?, Michelle Bemiller (Walsh U)
Getting Students Out of Their Own Heads: Teaching About Symbols and Shared Meaning, Peter Blum (Hillsdale C)
Cultivating Opportunities for Social Mobility through E-learning and Web 2.0 Technologies: An Experimental Study of an Online Learning Community, Michael Dickard (Ohio U)
The Engaged Class: Using Service-Learning and Community-Based Research When We Teach, Debra Swanson (Hope C)

1:30pm—2:30pm

- C10.1 Deep Learning in Sociology Courses (W)** Ballroom 4
 Organizer: Keith Roberts (Hanover C)

2:45pm—3:45pm

- C11.1 Human Rights (NCSSC)** Marquis C
 Moderator: John Krol (Washington & Jefferson C)
Female Genital Mutilation Across Africa, Marina Fayeze (Cleveland State U)
Human Trafficking in Moldova 2001-2011, Brandon Heckman (Washington & Jefferson C)
An Examination of Childhood Slavery Around the World, Samantha Barclay (Washington & Jefferson C)
- C11.2 Using Technology in the Classroom: Challenges and Opportunities** City Center B
 Organizer: Georgios Loizides (U of Wisconsin-Stout)
Using Technology in the Classroom: Challenges and Opportunities, Georgios Loizides (U of Wisconsin-Stout)
Teaching Statistics: Approaches and Logistics, Laci Fiala (Walsh U)
Teaching Sociology Online, Shondrah Nash (Morehead State U)

2:45pm—4:00pm**C12.1 Potpourri (NCSSC)**

Marquis B

Moderator: Gail McGuire (Indiana U-South Bend)

Examining the United States as an Imagined Community, Lance Bruchett (Indiana U-South Bend)*The Social Construction of Sustainability in the Tourism Industry*, Megan Albaugh Bonham (Indiana U-South Bend)*Understanding Death and the Evolution of Death Rituals: How Societies Deal with Issues Related to Death*, Sikholisile Nyoni (Indiana U-South Bend)*Suicide and the African American Male Population*, Jacob Hughes (Indiana U-South Bend)*Self-presentation on Facebook*, Ruth Jones (Indiana U-South Bend)**2:45pm—4:15pm****C13.1 Self, Identity, and Mental Health**

Ballroom 2

Organizer: Mary Gallagher (Kent State U)

*Testing the Effects of Bullying and Cyber-bullying on Self-Concept and Delinquency Using the**Pennsylvania Youth Survey*, Lindsay Kahle (Indiana U of Pennsylvania) and Christian Vaccaro (Indiana U of Pennsylvania)*Does Gender Moderate Depression in Young Adults who Experience Maltreatment*, Linda Lester (Oakland U)*Culture Shock among International Students*, Sofiya Arnaudova (Seton Hill U)*A Comparison of Victimization Risk from Alcohol, Marijuana and Other Drugs*, Karen Weis (West Virginia U) and Tom Wytiaz (West Virginia U)*Relationship Between Positive Deviance And Prejudice*, Lori Hale (U of Akron)**C13.2 Framing Deviance and Public Opinion**

Ballroom 3

Organizer: Patricia Case (U of Toledo)

Ten Years of Law and Order: Race and Social Class in Media Representations of Crime, Patricia Case (U of Toledo)*Inequalities in Mental Health as Evidence of Covert Institutional Violence*, Peter Barr (U of Akron) and Michael Steiner (U of Akron)*Marked for Life: Popular Cinematic Discourse on Dangerous Criminals*, Todd Callais (Independent Scholar) and Liz Dickerson (Ohio Dominican U)*A Social History of Hoarding Behavior*, Megan Shaeffer (Kent State U)**C13.3 Medical Sociology**

Ballroom 4

Organizer: Dorothy Kalanzi (Gannon U)

Getting and Giving: The Effect of Support on Multiple Measures of Health, Amy Irby-Shasanmi (Indiana U) and Christy Erving (Indiana U)*Remembering the Birds and the Bees: What Did We Learn in Sex Ed?*, Kathryn Messenger (Shippensburg U)*Developing Conceptual Framework for Measuring Quality of Life among Older Adults Aging with Cerebral Palsy*, Min Li (Youngstown State U)**C13.4 Notions of Family**

Ballroom 5

Organizer: TBA

Family Structure and Alcohol Use among High School Seniors, Andrew Forrai (Kent State U)*Adolescents & Illicit Drug Use: Examining how Self-Efficacy and Family Structure Play a Role in Marijuana Use*, Amber Hunter (Kent State U)*It's Just One Big Family: Constructing Voluntary Kinship in Domestic Violence Shelters*, Jessica Paull (Kent State U)*How Does Fatherhood and Gender Role Attitudes Affect Patterns of Alcohol Consumption Behaviors Among Middle-Class Working Men?*, Yukiha Maruyama (Kenyon C)*Divorce in Multicultural Perspective: A Field Study about Reasons for Divorce in Qatar*, Humoud Alqashan (Kuwait U)

C13.5 Food and Environmental Sustainability

Marquis A

Organizer: Tim Bauer (Western Michigan U)

Cash Crops and Their Role on Local Households in East Africa, Frank Annie (West Virginia U)*What the Frack is Going on in Michigan? Hydraulic Fracturing and the Future of Michigan's Great Lakes*, Elizabeth Bradshaw (Western Michigan U)*The Price of Profit: Environmental Justice and the 'Fracking Industry'*, Jacquelynn Doyon (Western Michigan U)*Sharing the Harvest: A Qualitative Study of Farmers' Market Managers' and Vendors' Social Motivations to Accept Food Entitlement Program Coupons*, Morgan Roddy (Ball State U)**2:45pm—5:15pm****C14.1 Teaching Idea Swap (W)**

City Center A

Organizer: Jackie Bergdahl (Wright State U)

Tips for Creating a New Course, Jackie Bergdahl (Wright State U)*Adding a Service/Community Component to a Course*, Broh Beckett (Capital U)*Exploring Boundaries: Personal Experiences in Teaching Difficult Subject Matter*, Pauline Acosta (Central Michigan U), Brigitte Bechtold (Central Michigan U), Amanda Garrison (Central Michigan U) and Donna Giuliani (Delta C)*Online Teaching Tips*, Michael Norris (Wright State U)*A Method to the Madness: The Value of Sharing Teaching Pedagogy in the Classroom*, Tracey Steele (Wright State U)*Churches and Cemeteries: Class Outside the Classroom*, Debra Swanson (Hope C)*Using Crumple Surveys for Sensitive Topics*, Lissa Yogan (Valparaiso U)**4:00pm—5:30pm****C15.1 Self and Identity (NCSSC)**

Marquis C

Moderator: Patricia Case (U of Toledo)

Like Kayne: Popular Music, Culture, and Self Among At-Risk Teens, Alexa Dorris (Denison U)*The Perceptions of Socioeconomic Status and Self-Esteem*, Alexandra Blair Elliott (Westminster C)*McSelf: How the Institutionalization of McDonaldization Affects Role Construction and Identity*, C. Sean Evans (The Ohio State U)*Redefining the Human Species Being: An Analysis of Cosmetic Surgery from a Post Humanist Perspective*, Danica Van Volkenburg (Wittenberg U)*Contested Nationalisms and the Appropriation of Village Artistic Forms in Bangladeshi Discourse*, Chelsea McGill (Denison U)**C15.2 Integrating Social Responsibility into Learning Strategies: Community Engagement and Ethics**

City Center B

Organizer: Beckett Broh (Capital U)

Conducting Community Based Research in the Undergraduate Research Methods Course, David Blouin (Indiana U-South Bend)*Emergent Learning in Social Research Methods: Ethics at the University*, Joshua Terchek (Case Western Reserve U), Adam Perzynski (Case Western Reserve U) and Nicole Deming (Case Western Reserve U)*Applying Service Learning in a Cross-Borders Program: A Multi-level Approach*, Jo Anna Kelly (Walsh U) and Penny Bove (Walsh U)*Problem-Based Service Learning: Construction, Implementation, and Assessment*, Beckett Broh (Capital U)**4:15pm—5:30pm****C16.1 Religion (NCSSC)**

Marquis B

Moderator: Laurie Russel Hatch (Ohio U)

Forgive and Forget? Religiosity and Perceptions of Ex-Offenders, Kelly Reidenbach (Saint Mary's C)*Declining Religious Behavior in College*, Melissa Amerman (Wilmington C of Ohio)*Age, Religiosity, Social Support, and Subjective Well-Being*, Robert Meeker (Hiram C)*The Effects of Religious Affiliation on Social Issues: A Comparison of Protestants, Catholics, and Non-Religious Students*, Laurel Foy (U of Pittsburgh)

4:30pm—5:30pm**C17.1 LGBTQ Studies**

Ballroom 2

Organizer: Cody Wedge (Western Michigan U)

Querying Communities: Exploring Relationships Between the Gay Community and Well Being, Jason G'Sell (U of Notre Dame)*Feminism as an Interruption to the Routine of Everyday Life: An Analysis of Feminism as a New Reality Utilizing Social Theorists Mead, Berger, and Luckmann*, Cheri Ellefson-Terhune (Ball State U)*Teaching about LGBTQ Issues*, Susan Alexander (Saint Mary's C)**C17.2 Gender & Crime in the Media**

Ballroom 3

Organizer: Rachel Stein (West Virginia U)

Depictions of Victims and Offenders in Television's Law and Order, Jared Rosenberger (U of Akron) and Valerie Callanan (U of Akron)*Female Action Characters in Popular Film: Femininity and Violence*, Rachel Stein (West Virginia U) and Jeannette Sanchez (West Virginia U)*Who Really Wears the Pants? An Analysis of Masculinity Through Male and Female Violent Action Characters*, Katherine Burns (West Virginia U)**C17.3 Media, Culture and Politics I**

Ballroom 5

Organizer: Joshua Woods (West Virginia U)

The Construction of Child Victims in Media, Amber Roby (Ohio Dominican U)*If You Can't Beat 'Em, Beat 'Em: Case Examples and Notes on Cultural Resistance and Annexation*, Peter Nieckarz, Jr (Western Carolina U)*Replacing Jobs With Ideology: Student Perceptions of the Economic Impact of the Coal Industry in West Virginia*, Debra Blaacker (West Virginia U)**C17.4 Sociology of Narrative**

Marquis A

Organizer: Larry Nichols (West Virginia U)

Organizations as Narrative Practice: Story-Based Identities in Higher Education, Larry Nichols (West Virginia U)*Weak Links and Warrior Hearts: A Framework for Judging Self and Others in Police Training*, Norman Conti (Duquesne U)*Creating Change with Industrial Narratives: the Story of the Anti-Stigma Industry in Mental Health*, Linda Morrison (Duquesne U)*Competing 'Thought Styles' in Child Welfare*, Corey Colyer (West Virginia U)**5:45pm—6:45pm****C18.1 Issues in Sociological Theory**

Ballroom 2

Organizer: Darrick Brake (Western Michigan U)

From Patricia Hill Collins to Dorothy Smith: Using Social Theory in the Classroom, Pauline Acosta (Central Michigan U), Brigitte Bechtold (Central Michigan U), Amanda Garrison (Central Michigan U) and Donna Giuliani (Delta C)*Major Issues in Contemporary Simmel Scholarship*, Peter Boenning (Jefferson Community C)*Integrative Theory and Specific Parenting Domains: Investigating the Compatibility Challenges of Social Learning and Social Control Theories*, Eric Jorrey (Ohio U)**C18.2 Preparing for a Departmental Review by the American Sociological Association's Departmental Resource Group (W)**

Ballroom 3

Organizer: Kathleen Piker-King (U of Mount Union)

C18.3 Media, Culture and Politics II

Ballroom 5

Organizer: Joshua Woods (West Virginia U)

The Mass Psychology of Conservatism: Why the Working Class Votes Republican, Timothy Jurkovic (BGSU Firelands)

C18.3 cont....Media, Culture and Politics II

Presidential Immigration Rhetoric: Negative Frames and Changing Political Culture, Damien Arthur (West Virginia U) and Joshua Woods (West Virginia U)
Immigrants in the News: An Epidemiological Approach to the Study of Negative News, Joshua Woods (West Virginia U) and Damien Arthur (West Virginia U)

C18.4 Crime Over the Life Course (P)

Organizer: Patrick Seffrin (Marywood U)

Marquis A

C18.5 Engaging Undergraduates in Research (P)

Organizer: Baranda Sawyers (Lansing Community C)

Marquis B

C18.6 Clickers and Other Interactive Technologies to Use Teaching Sociology

Organizer: Debra Swanson (Hope C)

Using Student Data from Interactive Student Response Systems to Introduce Sampling Bias and Generalizability, Jeffrey Seymour (U of Notre Dame)

Real Time Chat: Increasing Accessibility through Online Tools, Mauricia John (The Ohio State U) and Anjel Stough-Hunter (The Ohio State U)

Clicking Through Controversy: Clickers in Small Classrooms, Pamela Koch (Hope C)

City Center B

CSE3 Society of Women in Sociology Reception

Presiding: Kathy Feltey (U of Akron)

Ballroom 4

6:30pm—8:00pm

CSE4 NCSA Council Reception

Hosted by 2012 Executive Council

Rivers Room

Sunday, April 15

8:00am—9:00am

DSE1 20132 Program Committee Meeting

Presiding: Todd Callais (Independent Scholar)

Marquis A

9:00am—12:00pm

DSE2 New Council Meeting with Breakfast

Presiding: Steve Carlton-Ford (U of Cincinnati)

Marquis A



North Central Sociological Association

www.ncsanet.org

SATURDAY

SUNDAY

Scholarly Achievement Award

2012	Sarah Damaske, Pennsylvania State University
2011	Brian Powell, Indiana University, Catherine Bolzendal, Claudia Geist, and Lala Carr Steelman
2010	Allison C. Carey, Shippensburg University Nicole Rousseau, Kent State University
2009	Dan Zuberi, University of British Columbia
2008	Edward Morris, Ohio University
2007	Mansoor Moaddel, Eastern Michigan University
2006	no award given
2005	Peter and Patti Adler, University of Denver, University of Colorado Boulder
2004	no award given
2003	Douglas Harper, Duquesne University
2002	Lisa A. Keister, The Ohio State University
2001	no award given
2000	Mike Forrst Keen, Indiana University South Bend
1999	no award given
1998	Barry V. Johnston, Indiana University Northwest Betty A. Dobratz, Iowa State University, and Stephanie Shanks-Meile, Indiana University Northwest
1997	Larry T. Reynolds and Leonard Lieberman, Central Michigan University
1996	Donna Eder, Catherine Colleen Evans and Stephen Parker, Indiana University
1995	James B. McKee, Michigan State University
1994	David A. Snow, University of Arizona, and Leon Anderson, Ohio University Martin S. Weinberg, Colin Williams and Douglas Pryor, Indiana University
1993	Suzanne Staggenborg, McGill University
1992	no award given
1991	Francis B. McCrea, Grand Valley State University, and Gerald E. Markle
1990	Carolyn Perrucci, Robert Perrucci, Dana Targ and Harry Targ, Purdue University
1989	Larry T. Reynolds, Central Michigan University
1988	William J. Wilson, University of Chicago
1987	Philip Converse and Ray Pierce, University of Michigan
1986	Aldon Morris, University of Michigan Howard Schuman, University of Michigan, and Charlotte Steeh, University of Wisconsin–Milwaukee Lawrence Bobo, University of California Los Angeles, and Reynolds Farley, University of Michigan
1985	no award given
1984	Karl Schuesler, Indiana University
1983	Milton Yinger, Oberlin College
1982	Eleanor Wolf, Wayne State University
1981	Dwight B. Billings, Jr., University of Kentucky

John F. Schnabel Distinguished Contribution to Teaching Award

2012	Rebecca Bordt, DePauw University
2011	Lynn Richey, Raymond Walters College

Schnabel Teaching Award continued...

2010	Brian Powell, Indiana University Bernice A. Pescosolido, Indiana University
2009	Melinda Messineo, Ball State University
2008	Debra Swanson, Hope College
2007	Jay Weinstein, Eastern Michigan University
2006	Leslie T.C. Wang, University of Toledo
2005	Katherine Rowell, Sinclair Community College
2004	Susan Alexander, Saint Mary's College Kathy Feltey, University of Akron
2003	Charles Gallmeier, Indiana University Northwest
2002	Elizabeth Grauerholz, Purdue University
2001	Jay Howard, Indiana University/Purdue University Columbus
2000	Midwest Student Sociological Conference
1999	Pat Ashton, Indiana University / Purdue University Fort Wayne
1998	no award given
1997	John Macionis, Kenyon College
1996	Kathleen Piker King, Mount Union College
1995	Thomas Van Valey, Western Michigan University
1994	no award given
1993	Keith A. Roberts, Hanover College
1992	Theodore Wagenaar, Miami University
1991	Jeanne Ballantine, Wright State University
1990	William Ewens Michigan State University Al Chabot, Macomb Community College
1989	John Schnabel, West Virginia University
1988	no award given
1987	Reece McGee, Michigan State University

Aida Tomeh Distinguished Service Award

2012	Susan Alexander, Saint Mary's College
2011	Kathy Feltey, University of Akron
2010	Robert Shelly, The Ohio State University
2009	Bruce Keith, United States Military Academy
2008	Paula Dubeck, University of Cincinnati
2007	Barry Johnston, Indiana University Northwest
2006	Thomas Calhoun, Southern Illinois University
2005	Ellen Paige-Robin, Western Michigan University Tom Van Valey, Western Michigan University
2004	Kathleen Piker-King, Mount Union College
2003	Robert Newby, Central Michigan University
2002	Harry R. Potter, Purdue University
2001	Vicky Demos, University of Minnesota Morris
2000	no award given
1999	Dean A. Purdy, Bowling Green State University William E. Feinberg, University of Cincinnati
1998	Kent P. Schwirian, Ohio State University
1997	Keith Roberts, Hanover College

Tomeh Distinguished Service Award continued...

1996	Larry T. Reynolds, Central Michigan University
1995	Dean Targ, Purdue University
1994	Joseph Perry, Bowling Green State University
1993	Marcia Texler Segal, Indiana University Southwest
1992	Jeanne Ballantine, Wright State University
1991	William D'Antonio, University of Notre Dame
1990	no award given
1989	James Davidson, Purdue University Carolyn Perrucci, Purdue University
1988	Maryjoyce Green, Cleveland State University
1987	James McKee, Michigan State University
1986	Irwin Deutscher, University of Akron
1985	Wilbur Brookover, Michigan State University
1984	Ruth Useem, Michigan State University
1983	Paul Gustafson, College of Wooster
1982	Russel Dynes, Ohio State University Butler Jones, Ohio Wesleyan University John Useem, Michigan State University

J. Milton Yinger Distinguished Career in Sociology Award

2012	Keith Roberts, Hanover College
2011	Larry Reynolds, Central Michigan University
2010	Jeanne H. Ballantine, Wright State University
2009	Kent P. Schwirian, The Ohio State University
2008	Robert Perrucci, Purdue University
2007	J. Milton Yinger, Oberlin College

NCSA Presidents (1925-2012)

2012 -- 2013	Steve Carlton-Ford, University of Cincinnati
2011 – 2012	Lawrence Nichols, West Virginia University
2010 – 2011	J. I. (Hans) Bakker, University of Guelph
2009 – 2010	Kathy Rowell, Sinclair Community College
2008 – 2009	Jay Weinstein, Eastern Michigan University
2007 – 2008	Robert Shelly, Ohio University
2006 – 2007	Jay Howard, Indiana University-Purdue University, Columbus
2005 – 2006	Kathy Feltey, University of Akron
2004 – 2005	Kent Schwirian, Ohio State University
2003 – 2004	Bruce Keith, United States Military Academy
2002 – 2003	Tom Calhoun, Southern Illinois University
2001 – 2002	Paula Dubeck, University of Cincinnati
2000 – 2001	Joseph Perry, Bowling Green State University
1999 – 2000	Keith A. Roberts, Hanover College
1998 – 1999	Marcia Texler Segal, Indiana University Southeast
1997 – 1998	Harry R. Potter, Purdue University
1996 – 1997	Robert Newby, Central Michigan University
1995 – 1996	Vicky Demos, University of Minnesota-Morris
1994 – 1995	Jeanne Ballantine, Wright State University
1993 – 1994	Ellen K. Page-Robin, Western Michigan University
1992 – 1993	Dana Vannoy, University of Cincinnati
1991 – 1992	Reece McGee, Purdue University
1990 – 1991	Larry T. Reynolds, Central Michigan University
1989 – 1990	Marvin E. Olson, Michigan State University
1988 – 1989	Dena B. Targ, Purdue University
1987 – 1988	Laurel Richardson, Ohio State University
1986 – 1987	Norris R. Johnson, University of Cincinnati
1985 – 1986	Carolyn C. Perrucci, Purdue University
1984 – 1985	James Davidson, Purdue University
1983 – 1984	Joseph Scott, University of Notre Dame
1982 – 1983	Simon Dinitz, Ohio State University
1981 – 1982	William Faunce, Michigan State University
1980 – 1981	Irwin Deutscher, University of Akron
1979 – 1980	Sheldon Stryker, Indiana University
1978 – 1979	Ruth Hill Useem, Michigan State University
1977 – 1978	Dean K. Knudsen, Purdue University
1976 – 1977	Austin T. Turk, Indiana University
1975 – 1976	Shirley Angrist, Carnegie Mellon University
1974 – 1975	Marie R. Haug, Case Western Reserve University
1973 – 1974	Robert Perrucci, Purdue University
1972 – 1973	Russell Dynes, Ohio State University
1971 – 1972	Frank Westie, Indiana University
1970 – 1971	John Useem, Michigan State University
1969 – 1970	Dwight G. Dean, Iowa State University
1968 – 1969	William V. D'Antonio, University of Notre Dame
1967 – 1968	Delbert Miller, Indiana University
1966 – 1967	James B. McKee, Michigan State University
1965 – 1966	Albert J. Reiss, Jr., University of Michigan

NCSA Presidents continued...

1964 – 1965	Karl Schuessler, Indiana University
1963 – 1964	Butler A. Jones, Ohio Wesleyan University
1962 – 1963	Marvin B. Sussman, Western Reserve University
1961 – 1962	Wilbur B. Brookover, Michigan State University
1960 – 1961	Harold A. Gibbard, West Virginia University
1959 – 1960	Louis Schneider, Purdue University
1958 – 1959	Clifford Kirkpatrick, Indiana University
1957 – 1958	J. E. Fleming, Kent State University
1956 – 1957	Edgar A. Schular, Wayne State University
1955 – 1956	M. C. Elmer, University of Pittsburgh
1954 – 1955	Brewton Berry, Ohio State University
1953 – 1954	Harold T. Christensen, Purdue University
1952 – 1953	Raymond F. Sletto, Ohio State University
1951 – 1952	William H. Form, Michigan State University
1950 – 1951	J. Milton Yinger, Oberlin College
1949 – 1950	H. Warren Dunham, Wayne State University
1948 – 1949	William F. Cottrell, Miami University
1947 – 1948	Perry P. Denunej, Ohio State University
1946 – 1947	James T. Laing, Kent State University
1944 – 1946	Lloyd A. Cook, Ohio State University
1942 – 1944	Guy W. Savis, Ohio Wesleyan University
1941 – 1942	E. H. Sutherland, Indiana University
1940 – 1941	Charles R. Hoffer, Michigan State University
1939 – 1940	M. C. Elmer, University of Pittsburgh
1938 – 1939	J. E. Culter, Western Reserve University
1937 – 1938	Frederick E. Lurnley, Ohio State University
1936 – 1937	Archibald A. Johnston, College of Wooster
1935 – 1936	James A. Quinn, University of Cincinnati
1934 – 1935	J. E. Hagerty, Ohio State University
1933 – 1934	Reed Bain, Miami University
1932 – 1933	Herbert Miller, Ohio State University
1931 – 1932	Charles W. Coulter, Ohio Wesleyan University
1930 – 1931	Cecil C. North, Ohio State University
1929 – 1930	Issac E. Ash, Ohio University
1928 – 1929	Frederick G. Detweiler, Denison University
1927 – 1928	Charles J. Bushnell, University of Toledo
1926 – 1927	Earle E. Eubank, University of Cincinnati
1925 – 1926	Newell L. Sims, Oberlin College



Presenters

Last	First	Institution	Email
Abbott	Jessica	Thiel College	jabbott@thiel.edu
Acosta	Pauline	Central Michigan University	acost1ps@cmich.edu
Adams	Richard	Kent State University	radams12@kent.edu
Alexander	Ellen	Case Western Reserve University	ellen.alexander@case.edu
Alexander	Susan	Saint Mary's College	salexand@saintmarys.edu
Ali	Yousuf	Kuwait University	yousuf_ali_@hotmail.com
Alqashan	Humoud	Kuwait University	hq1965@yahoo.com
Anderson	Paul	University of Cincinnati	anderspu@mail.uc.edu
Annie	Frank	West Virginia University	fannie@mix.wvu.edu
Anthony	Robert	The Ohio State University	anthony.74@sociology.osu.edu
Arnaudova	Sofiya	Seton Hill University	arn6491@setonhill.edu
Arnold	Caroline	Brooklyn College	cea1000@gmail.com
Arthur	Damien	West Virginia University	damien.arthur@mail.wvu.edu
Asadi	Muhammed	Southern Illinois University-Carbondale	masadi@siu.edu
Ayers	Lindsey	Kent State University	layers2@kent.edu
Bakker	Hans	University of Guelph	hbakker@uoguelph.ca
Balmer	Rebekah	West Chester University	rb649636@wcupa.edu
Banerjee	Dina	Shippensburg University	dbanerjee@ship.edu
Barnes	Katherine	University of Louisville	krb.2006@yahoo.com
Barr	Peter	University of Akron	pbb2@zips.uakron.edu
Bauer	Tim	Western Michigan University	timothy.e.bauer@wmich.edu
Bechtold	Brigitte	Central Michigan University	becht1bh@cmich.edu
Becker	Paul	University of Dayton	Paul.Becker@notes.udayton.edu
Beckett	Broh	Capital University	bbroh@capital.edu
Bemiller	Michelle	Walsh University	mbemiller@walsh.edu
Bennett	Stephanie	The College of St. Rose	Bennetts@strose.edu
Bergdahl	Jackie	Wright State University	jacqueline.bergdahl@wright.edu
Blaacker	Debra	West Virginia University	dblaacke@mix.wvu.edu
Blackwood	Andria	Kent State University	ablackwo@kent.edu
Blee	Kathleen	University of Pittsburgh	kblee@pitt.edu
Blouin	David	Indiana University-South Bend	dblouin@iusb.edu
Blum	Peter	Hillsdale College	pblum@hillsdale.edu
Boatner	Anne	Brooklyn College	annesque@gmail.com

Last	First	Institution	Email
Boenning	Peter	Jefferson Community College	pboenning@sunyjefferson.edu
Boggs	Wade Thomas	Ohio Northern University	w-boggs@onu.edu
Bordt	Rebecca	DePauw University	rbordt@depauw.edu
Bove	Penny	Walsh University	pbove@walsh.edu
Bradley	Christopher	Indiana University Purdue University Fort Wayne	bradleyc@ipfw.edu
Bradshaw	Elizabeth	Western Michigan University	elizabeth.a.bradshaw@wmich.edu
Brake	Darrick	Western Michigan University	darrick.l.brake@wmich.edu
Brewster	Zachary	Wayne State University	zbrewster@wayne.edu
Briesacher	Alex	Kent State University	abriesac@kent.edu
Broh	Beckett	Capital University	bbroh@capital.edu
Brooks	Rebecca	Ohio Northern University	r-brooks.1@onu.edu
Broyles	Phillip	Shippensburg University	pabroy@ship.edu
Burns	Katherine	West Virginia University	kburns7@mix.wvu.edu
Callais	Todd	Independent Scholar	tcallais@gmail.com
Callanan	Valerie	University of Akron	Vcallana@uakron.edu
Carrothers	Robert	Ohio Northern University	r-carrothers@onu.edu
Carter	Jennifer	University of Cincinnati	carterja@mail.uc.edu
Case	Patricia	University of Toledo	Patricia.Case@utoledo.edu
Chesney	Barbara	University of Toledo	barabara.chesney@utoledo.edu
Christy	Chelsea	Muskingum University	cchristie@muskingum.edu
Clark	Richard	John Carroll University	rclark@jcu.edu
Cocroft	Shelytia	Wayne State University	shelytia@sbcglobal.net
Colyer	Corey	West Virginia University	Corey.Colyer@mail.wvu.edu
Condon	Josalie	Kent State University	jcondon1@kent.edu
Conner	Kelsie	West Virginia University	kconner2@mix.wvu.edu
Conti	Norman	Duquesne University	normanconti@gmail.com
Cottingham	Marci	University of Akron	mdc63@uakron.edu
Culler	Krystal	University of Akron	klc65@zips.uakron.edu
Cummins-Sebree	Sarah	University of Cincinnati- Blue Ash College	cumminsh@ucmail.edu
Curtis	Henry	University of Louisville	Hecurt01@louisville.edu
Czekaj	Anna	Case Western Reserve University	anna.czekaj@case.edu
Davies	Chris	West Virginia University	cdavies@mix.wvu.edu
Deemer	Danielle	The Ohio State University	deemer.7@osu.edu

Last	First	Institution	Email
Deming	Nicole	Case Western Reserve University	nicole.deming@case.edu
Denison	Barbara Jones	Shippensburg University	bjdeni@ship.edu
Desmond	Scott	Indiana University Purdue University Indianapolis	sadesmon@iupui.edu
Dickard	Michael	Ohio University	md240205@ohio.edu
Dickerson	Liz	Ohio Dominican University	dicksone@ohiodominican.edu
Dickson	Liz	Ohio Dominican University	dicksone@ohiodominican.edu
Dietz	Bernadette	University of Cincinnati	bernadete.dietz@uc.edu
Doyon	Jacquelynn	Western Michigan University	jacquelynn.a.doyon@wmich.edu
Dukes	Duane	John Carroll University	dukes@jcu.edu
Dwyer	Mary	West Virginia University	mdwyer4@mix.wvu.edu
Edwards	September	Ohio Dominican University	edwardss2@ohiodominican.edu
Eichenberger	Susan	Seton Hill University	eichenberger@setonhil.edu
Ellefson-Terhune	Cheri	Ball State University	clellefson@bsu.edu
Elrod	Leslie	University of Cincinnati	Leslie.elrod@uc.edu
Erickson	Rebecca	University of Akron	rericks@uakron.edu
Erlin	Carrie	Saint Mary's College	cerlin@saintmary.edu
Erving	Christy	Indiana University	cerving@indiana.edu
Eslinger	Kenneth	John Carroll University	desling@falcon.bgsu.edu
Everhardt	Sharon Lindhorst	Lourdes University	severhar@lourdes.edu
Eyck	Toby Ten	Michigan State University	teneyck@msu.edu
Fahs	Breanne	Arizona State University	Breanne.Fahs@asu.edu
Faruquee	Kemal	Pennsylvania State University	kbf5044@psu.edu
Fasoli	Allison DiBianca	University of Chicago	adibianc@uchicago.edu
Fazlagic	Muhamed	University of Louisville	mafazl01@louisville.edu
Feltey	Kathryn	University of Akron	felteyk@uakron.edu
Fiala	Laci	Walsh University	lfialaades@walsh.edu
Fine	Leigh	The Ohio State University	sociology@leighfine.com
Fischer	Brette	Michigan State University	fisch156@msu.edu
Fitch	Chivon	Kent State University	cfitch1@kent.edu
Forrai	Andrew	Kent State University	aforrai@kent.edu
Freis-Beattie	Reinmar	West Virginia University	rfreisbe@gmail.com

Last	First	Institution	Email
Fukushima	Rina	California State University - Sacramento	rf557@csus.edu
Gallagher	Mary	Kent State University	mngallag@kent.edu
Garci	Adriana	University of Notre Dame	agarci16@nd.edu
Garrison	Amanda	Central Michigan University	garri2ae@cmich.edu
Geleta	Esaya Bekele	University of Limerick, Ireland	bekeesay@yahoo.com
Giuliani	Donna	Delta College	donnagiuliani@delta.edu
Goar	Carla	Kent State University	cgoar@kent.edu
Gordon	Lindsey	West Virginia University	lgordon2@mix.wvu.edu
Graham	Ciera	University of Cincinnati	grahamc6@mail.uc.edu
Gray IV	R. Paul	The University of Iowa	richard-gray@uiowa.edu
Green	Aaryn	University of Cincinnati	greena3@mail.uc.edu
Griffith	Casey	University of Louisville	casey.griffith@louisville.edu
Gruettert	Jeffrey	Indiana University Purdue University Fort Wayne	gruejm01@students.ipfw.edu
G'Sell	Jason	University of Notre Dame	jgsell@nd.edu
Gualtieri	Gillian	Kenyon College	gualtierig@kenyon.edu
Gutierrez	Daniel	Indiana University Purdue University Fort Wayne	gutierrezdan4@gmail.com
Haber-Barker	Natalie	Northwestern University	nhaberbarker@childrensmemorial.org
Hale	Lori	University of Akron	lh55@zips.uakron.edu
Haney	Austin	Kent State University	shaney3@kent.edu
Hara	Bastas	University of Cincinnati - Blue Ash College	bastash@ucmail.uc.edu
Hart	Julie	Ohio Dominican University	hartj@ohiodominican.edu
Hartman	Julie	Frostburg State University	jehartman@frostburg.edu
Harvell	Kalvin DaRonne	Henry Ford Community College	kharvell@hfcc.edu
Hass	Jeffrey	University of Richmond	jhass@richmond.edu
Heeb	Katherine	Texas A&M University- Corpus Christi	kchavez@islander.tamucc.edu
Hesseling	Derek	Ohio Dominican University	hesselid@ohiodominican.edu
Hickman	Lisa	Grand Valley State University	hickmanl@gvsu.edu

Last	First	Institution	Email
Hillsman	Sally	American Sociological Association	hillsman@asanet.org
House	Arielle	Ohio Northern University	a-house@onu.edu
Howell	Terra	University of Akron	thowell2@kent.edu
Huggins	Chris	University of Kentucky	
Hunter	Amber	Kent State University	ahunte11@kent.edu
Hussain	Fayyaz	Michigan State University	hussain3@msu.edu
Irby-Shasanmi	Amy	Indiana University	airby@indiana.edu
Janos	Sara	Michigan State University	janossar@msu.edu
Jiang	Zhan	University of Louisville	z0jian05@louisville.edu
Jimenez	Kathryn	University of Cincinnati	jimeneke@mail.uc.edu
John	Mauricia	The Ohio State University	john.54@osu.edu
Johns-Wolfe	Elaina	Indiana University Purdue University Fort Wayne	johnem03@students.ipfw.edu
Jones	Caralee	Indiana University	jonescg@indiana.edu
Jorrey	Eric	Ohio University	jorrey@ohio.edu
Jurkovic	Timothy	BGSU Firelands	tjohnj@bgsu.edu
Kahle	Lindsay	Indiana University of Pennsylvania	l.l.kahle@iup.edu
Katz	Rebecca	Morehead State University	r.katz@moreheadstate.edu
Keenan	Christopher	The Ohio State University	keenan.56@osu.edu
Kelly	Jo Anna	Walsh University	jkelly@walsh.edu
Kerbi	Jeri	West Virginia University	jkirby2@mix.wvu.edu
Keto	Stephen	Kent State University	
Khalili	Ahmad	Slippery Rock University	ahmad.khalili@sru.edu
Killian	Mark	University of Cincinnati	killiamp@mail.uc.edu
Kilpatrick	Quentin	Ohio University	qk198610@ohio.edu
Kimmel	Chad	Shippensburg University	cmkimm@ship.edu
Kimura-Ida	Aya	California State University - Sacramento	idaa@csus.edu
Klotz	Johanna	Chatham University	jklotz@chatham.edu
Koch	Pamela	Hope College	koehp@hope.edu
Kosla	Martin	The Ohio State University	kosla.3@sociology.osu.edu
Koufopoulou	Sophia	University of Crete, Greece	

Last	First	Institution	Email
Kraus	Rachel	Ball State University	rmkraus@bsu.edu
Kreiter	Ryan	Muskingum University	rkreuter@muskingum.edu
Kruse	Lisa Marie	Western Michigan University	lisa.m.kruse@wmich.edu
Kucher	Anastasiia	West Virginia University	akucher@mix.wvu.edu
Lauber	Dane	Shippensburg University	
Lavin-Loucks	Danielle	Valparaiso University	danielle.lavin-loucks@valpo.edu
Lee	Alicia	University of Pennsylvania	alicial@sas.upenn.edu
Lee	Matthew	University of Akron	mlee2@uakron.edu
Leshko	Christina	Michigan State University	leshkoch@msu.edu
Lester	Linda	Oakland University	ldlester@oakland.edu
Leveto	Jessica	Kent State University	jleveto@kent.edu
Lewis	Jerry	Kent State University	jlewis@kent.edu
Li	Min	Youngstown State University	mli01@ysu.edu
Liang	Ying	Kent State University	yliang3@kent.edu
Linders	Annulla	University of Cincinnati	lindera@ucmail.uc.edu
Littrell	Michael	University of Louisville	michael.littrell@louisville.edu
Loehr	Annalise	Indiana University	aloehr@indiana.edu
Loizides	Georgios	University of Wisconsin - Stout	loizidesg@uwstout.edu
Lomire	Patricia	Minot State University	patriciaann.pa@gmail.com
Malone	Chad	The Ohio State University	malone.61@sociology.osu.edu
Martin	James	Indiana University of Pennsylvania	j.s.martin@iup.edu
Maruyama	Yukiha	Kenyon College	maruyamay@kenyon.edu
Matz	Jacob	West Virginia University	jmatz1@mix.wvu.edu
McCarthy	Wanda	University of Cincinnati	wanda.mccarthy@uc.edu
McGrath	Shelly	University of Alabama	smcgrath@uab.edu
McGuire	Steve	Muskingum University	mcguiresteve93@gmail.com
McKinely	Liz	Michigan State University	lizmck03@gmail.com
Mesch	Gustavo	University of Haifa, Israel	gustavo@soc.haifa.ac.il
Messenger	Kathryn	Shippensburg University	km9585@ship.edu
Messineo	Melinda	Ball State University	mmessine@bsu.edu
Metz	Kim	Walsh University	kmetz@walsh.edu
Miller	Paula	Michigan State University	mille995@msu.edu
Mitchell	Megan	Agnes Scott College	mmmitchell@agnesscott.edu
Morrison	Linda	Duquesne University	morrison12841@duq.edu

Last	First	Institution	Email
Mortensen	Terry	Kent State University	terrymortensen@gmail.com
Mozdy	Andrew	University of Pittsburgh	amm244@pitt.edu
Mullan	Brendan	Michigan State University	Mullan@Msu.edu
Nash	Shondrah	Morehead State University	s.nash@moreheadstate.edu
Neal	Zachary	Michigan State University	zpneal@msu.edu
Neilson	Lisa	The Ohio State University	neilson.10@osu.edu
Nichols	Lawrence	West Virginia University	Larry.Nichols@mail.wvu.edu
Nieckarz, Jr.	Peter	Western Carolina University	pnieckarz@wcu.edu
Nigem	Elias	University Of Toledo	Enigem@utnet.utoledo.edu
Nolan	James	West Virginia University	jnolan2@wvu.edu
Norris	Michael	Wright State University	michael.norris@wright.edu
Norwood	Carolette	University of Cincinnati	carolette.norwood@uc.edu
Novisky	Meghan	Kent State University	mnovisky@kent.edu
Nyoni	Kisholisile	Indiana University-South Bend	nyonsikh@umail.iu.edu
Oliva	Monica	University of Akron	moliva84@gmail.com
Osani	Mikala	Case Western Reserve University	mikala.osani@case.edu
Oyabu-Mathis	Naoko	University of Mount Union	oyabumn@mountunion.edu
Paharik	James	Seton Hill University	jpaharik@setonhill.edu
Pantaleo	Katie	Lock Haven University	kpantale@lhup.edu
Park	Kristin	Westminster College, PA	kpark@westminster.edu
Patal	Sharad	West Virginia University	spatel8@mix.wvu.edu
Paull	Jessica	Kent State University	jpaul@kent.edu
Perkins	Jacob	Indiana University Purdue University Fort Wayne	perkjj01@students.ipfw.edu
Perzynski	Adam	Case Western Reserve University	Adam.Perzynski@case.edu
Petten	Irene	Columbus State Community College	ipetten@csc.edu
Petten	Irene	Columbus State Community College	ipetten@csc.edu
Phillips	Lora	Kent State University	lphill1@kent.edu
Piker-King	Kathleen	University of Mount Union	kingkd@mountunion.edu
Proctor	Janice	Ohio University's Eastern Campus	proctorj@ohio.edu

Last	First	Institution	Email
Pruitt	Allison	University of Louisville	asprui01@louisville.edu
Prus	Robert	University of Waterloo	prus@uwaterloo.ca
Purcell	David	Kent State University	dpurcell@kent.edu
Purdy	Simon	Western Michigan University	simon.j.purdy@wmich.edu
Putri	Ully	University of Colorado at Boulder	ully.putri@colorado.edu
Quinsaatt	Sharon Madriaga	University of Pittsburgh	smq5@pitt.edu
Reamy	Amber Betony	Ohio Northern University	a-reamy@onu.edu
Redmond	Deidre Lynn	Indiana University	dlredmon@indiana.edu
Reeder	Rebecca	University of Cincinnati	reederra@mail.uc.edu
Reidinger	Bobbi	Kent State University	breiding@kent.edu
Rinehart	Aaron	Kent State University	aerineha@kent.edu
Ritchey	Lynn	University of Cincinnati-Blue Ash College	lynn.ritchey@uc.edu
Ritchey	P. Neal	University of Cincinnati	phillip.ritchey@uc.edu
Roberts	Keith	Hanover College	robertsk@hanover.edu
Roby	Amber	Ohio Dominican University	robya@ohiodominican.edu
Roddy	Morgan	Ball State University	mrroddy@bsu.edu
Rosenberger	Jared	University of Akron	jsr26@zips.uakron.edu
Rosino	Michael	University of Cincinnati	rosinoml@mail.uc.edu
Ross	Betsy	Baldwin Wallace College	eross@bw.edu
Samblanet	Sarah	Kent State University	ssamblan@kent.edu
Sampsel	Vanessa	Indiana University Purdue University Fort Wayne	sampvm01@students.ipfw.edu
Sanchez	Jeannette	West Virginia University	jsanche2@mix.wvu.edu
Sawyers	Baranda	Lansing Community College	barandasawyers@gmail.com
Scanlan	Stephen	The Ohio State University	scanlans@ohio.edu
Schmidt	Marshall	West Virginia University	mschmid7@mix.wvu.edu
Schneider	Rachel	University of Akron	raz3@uakron.edu
Schnelker	Glenn	Indiana University Purdue University Fort Wayne	schngk01@students.ipfw.edu
Schock	Timothy	Shippensburg University	ts3014@ship.edu
Schottenstein	Harlan	Franklin University	schotteh@franklin.edu
Schwirian	Kent	The Ohio State University	schwirian.2@sociology.osu.edu
Scott	Shane	University of Louisville	stscot02@louisville.edu

Last	First	Institution	Email
Seffrin	Patrick	Marywood University	seffrin@marywood.edu
Senter	Mary	Central Michigan University	Mary.Senter@cmich.edu
Seymour	Jeffrey	University of Notre Dame	seymour.10@nd.edu
Shaeffer	Megan	Kent State University	mshaeff1@kent.edu
Shelby	Robert	University of Louisville	rlshel04@cardmail.louisville.edu
Shin	Jean	American Sociological Association	shin@asanet.org
Shupe	Frances	University of Louisville	flshup01@louisville.edu
Simmons	Clara	West Virginia University	csimmon9@mix.wvu.edu
Sinclair	Alexander	Hiram College	sinclairas@my.hiram.edu
Sinski	Jennifer Blevins	University of Louisville	jbsins01@louisville.edu
Skoczylas	Marie	University of Pittsburgh	mbs@pitt.edu
Smith	Amanda Marie	Western Michigan University	Amanda.M20.Smith@wmich.edu
Smith	Brian	Central Michigan University	smith1b@cmich.edu
Smith	Michelle	Lakeland Community College	msmith@lakelandcc.edu
Sommerkorn	Ryan	West Virginia University	rsommerk@mix.wvu.edu
Spiker	Russell	University of Cincinnati	spikerrl@mail.uc.edu
Stack	Scarlett	University of Cincinnati	stackks@mail.uc.edu
Steele	Jennifer	West Virginia University	jksteele@mail.wvu.edu
Steele	Tracey	Wright State University	tracey.steele@wright.edu
Steidley	Trent	The Ohio State University	steidley.1@buckeyemail.osu.edu
Stein	Rachel	West Virginia University	rachel.stein@mail.wvu.edu
Steiner	Michael	The University of Akron	mcs57@zips.uakron.edu
Stevens	Rebecca	West Virginia University	rstevens510@gmail.com
Stone	Maggie	University of Louisville	maggie.stone@louisville.edu
Stooksberry	Jodi	University of Cincinnati	stooksjn@ucmail.uc.edu
Stough-Hunter	Anjel	The Ohio State University	stough-hunter.1@buckeyemail.osu.edu
Sullivan	Jessica	Western Michigan University	jessica.r.sullivan@wmich.edu
Swank	Eric	Morehead State University	e.swank@morehead-st.edu
Swanson	Debra	Hope College	swansond@hope.edu
Tabachnick	David	Muskingum University	dtabach@muskingum.edu
Terchek	Joshua	Case Western Reserve University	Joshua.Terchek@case.edu
Terhune	Cheri Ellefson	Ball State University	clellefson@bsu.edu

Last	First	Institution	Email
Tillman	Scott	Case Western Reserve University	scott.tillman@case.edu
Tregea	Bill	Adrian	wtregea@adrian.edu
Tuominen	Mary	Denison University	tuominen@denison.edu
Vaccaro	Christian	Indiana University of Pennsylvania	cvaccaro@gmail.com
Van Valey	Thomas	Western Michigan University	thomas.vanvaley@wmich.edu
Vines	Marcus	University of Cincinnati	mvines25@yahoo.com
Walker	Ruth	University of Akron	rvw3@zips.uakron.edu
Wang	Leslie T. C.	Saint Mary's College	lwang@saintmarys.edu
Wedge	Cody	Western Michigan University	cody.l.wedge@wmich.edu
Weidman	John	University of Pittsburgh	weidman@pitt.edu
Weiss	Karen	West Virginia University	karen.weiss@mail.wvu.edu
Weitzel	Nicholas	Western Carolina University	naweitzel@catamount.wcu.edu
White	Robyn	Cuyahoga Community College	rw46@zips.uakron.edu
Wiedenhof Murphy	Wendy	John Carroll University	wwiedenhof@jcu.edu
Wills	Jeremiah	Queens University	willsj@queens.edu
Wisecup	Christopher	University of Louisville	chriswisecup@gmail.com
Woldoff	Rachael	West Virginia University	rachael.woldoff@mail.wvu.edu
Woods	Joshua	West Virginia University	joshua.woods@mail.wvu.edu
Wornick	Tommy Wayne	University of Texas at Dallas	tww051000@utdallas.edu
Wright	Cody	Central Michigan University	wrigh2ca@cmich.edu
Wytiacz	Tom	West Virginia University	twytiacz@mix.wvu.edu
Yamada	Mieko	Indiana University Purdue University Fort Wayne	yamadam@ipfw.edu
Yang	Ying	Shippensburg University	yyang@ship.edu
Yogan	Lissa	Valparaiso University	lissa.yogan@valpo.edu
Yousif Al- Kandari	Yagoub	Kuwait University	alkandari66@hotmail.com

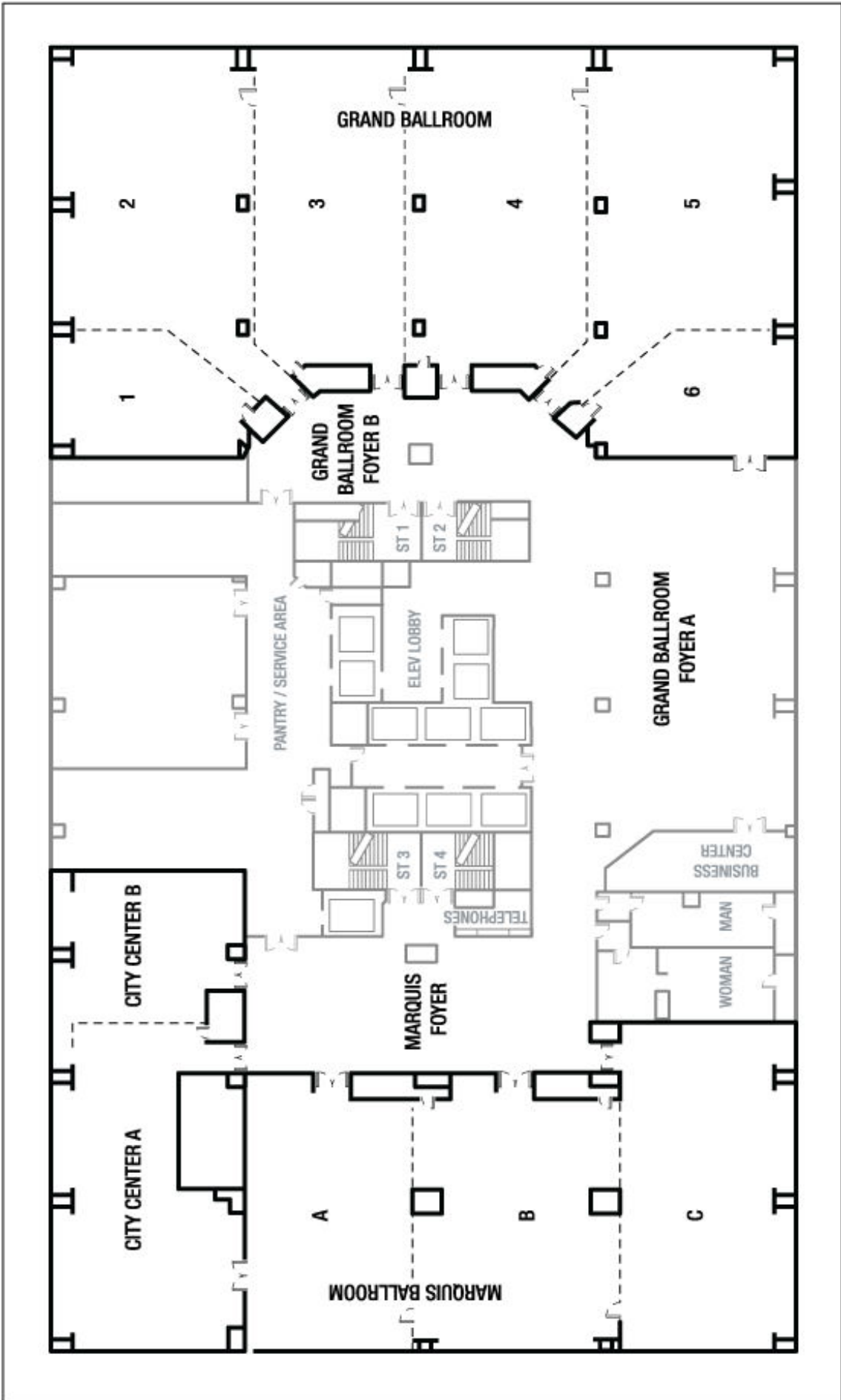



INDIANAPOLIS 2013

**April 4—7, 2013
Crowne Plaza Union Station**

Why meet in Indy?

-150 flights arrive and depart every day
-more than 50% of U.S. population lives within a day's drive
-200 restaurants within one mile of conference hotel
-dozens of cultural, educational and historical attractions close by
-6 cultural districts ensures something for everyone

Mark Your Calendars

March 27-30, 2014

Cincinnati, Ohio

Hyatt Regency